

# PRESSNET



# FANGBANG

The Setter of National Standard of  
Roll-fed Square Bottom Paper Bag Machine

JianShe® FANGBANG HANCENT



Craftsmanship Spirit  
for 45 Years

江苏 方邦集团



# PRESSNET



**The Setter of National Standard of Roll-fed Square Bottom Paper Bag Machine**

**The Manufacture Organization of Jiangsu Province First Great Equipment (Fully Auto Sheet-fed Paper Bag Machine)**

Jiangsu Fangbang Group was founded in 1990, which has 2 fully owned subsidiaries, including Jiangsu Fangbang Machinery Co., Ltd. (Headquarter) and Zhejiang Hancent Technology Co., Ltd. (New Production Base). By supplying printing machines and packaging machines, Fangbang Group strives to offer the best production solutions to various printing and packaging requirements of the customers all over the world.

Fangbang Group is equipped with world-class Multi-axis & Turning-Milling Compound processing equipment, including German DMG MORI, Spanish Nicolas Correa, Korean Doosan and so on. Meanwhile the laboratory is equipped with Zeiss 3-coordinate measuring machine and other inspecting machines, so that we can ensure the processing and inspecting Accuracy of spare parts, to obtain overall reliability and operational stability.

After 30 years devotion on research, Fangbang Group has gained more than 120 patents and 16 software/work copyrights, and has passed GB/T19001-2016/ISO9001:2015 International Quality System Certification, GB/T 29490:2013 Intellectual Property Management System Certification, etc., and all products are certified by CE.

The customers of Fangbang Group are from countries/regions all over the world, including South-east Asia, Middle East, Europe, America, Australia and Africa. And they use our machines to offer printing and bags to many internationally famous brands, such as KFC, McDonald's, Starbucks, Luckin Coffee, Anta and Uniqlo, etc.

Fangbang team insists on the concept of technology leading and quality first to offer the best products and service to customers. "Be dependable friend of customers" is our purpose, "Create value for customers" is our goal. "JianShe" brand products are your best choice: we sincerely welcome old and new customers to cooperate with Fangbang and make progress together.



## Headquarter

Jiangsu Fangbang Machinery (Suzhou • Jiangsu)



Zhejiang Hancent Technology (Wenzhou • Zhejiang)



Jiangsu Fangbang Machinery is a high-tech enterprise including research and development, production, sales and service, located in Suzhou China, covering an area more than 30,000 square meters. This company is specialized in the production of paper bag making machines (sheet paper feeding, roll paper feeding, full-automatic, semi-automatic and so on). Our company has the right to import and export. Now we have more than 30 offices in China and abroad, and have established a perfect after-sales service system to ensure that we can provide strong technical support and attentive, efficient service for customers.

## New Production Base

Zhejiang Hancent Technology is located in Wenzhou China, and was officially put into use in March 2022. As the new production base of Fangbang group, it has 7 buildings and covers an area more than 100,000 square meters. In this factory we are committed to the research and production of valve sack machines, paper bag machine and flexo printing machines. With the ability of annual production capacity of 300 paper bag machines, Hancent will work together with Jiangsu Fangbang to provide global customers with more perfect products and services.

# HAS BEEN LEADING THE INDUSTRY

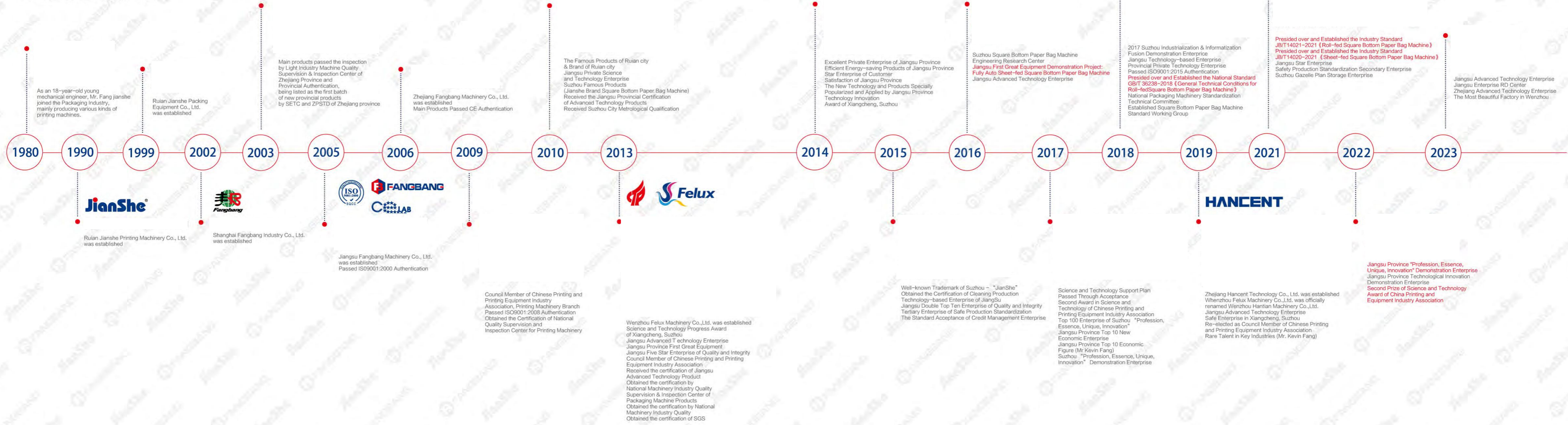

## PRODUCTION WORKSHOP

We insist on the concept of  
“Technology Leading & Quality First”

## CLIENTS' FACTORIES

The purpose of fangbang team  
is to create more values for customers

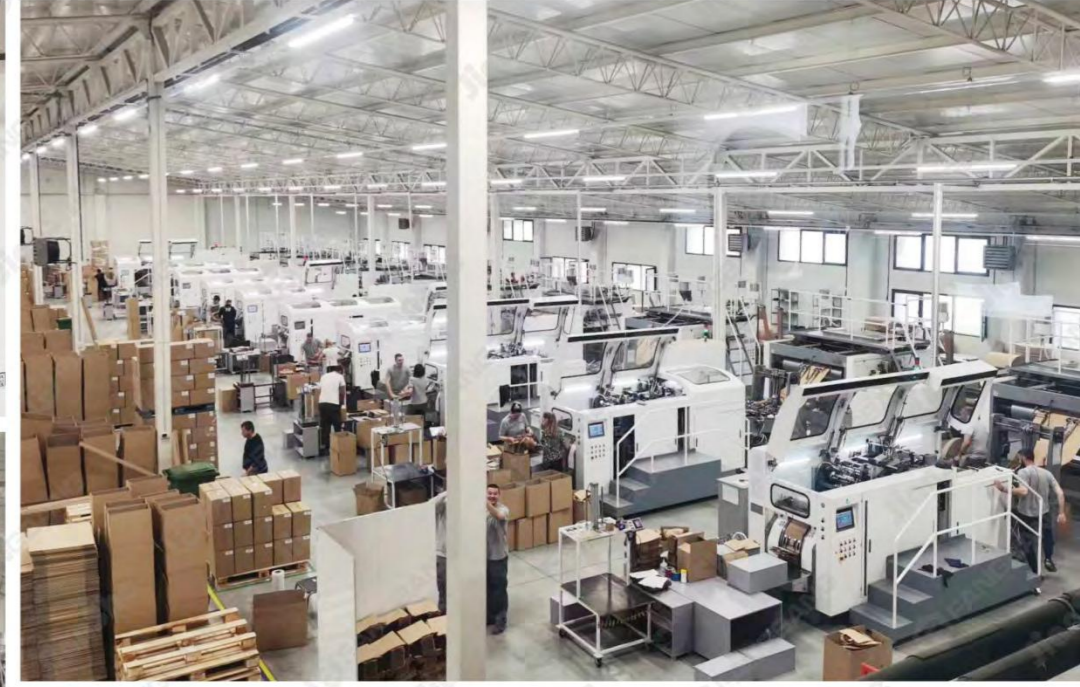

Whatever you required,  
Fangbang can supply all the most perfect solutions

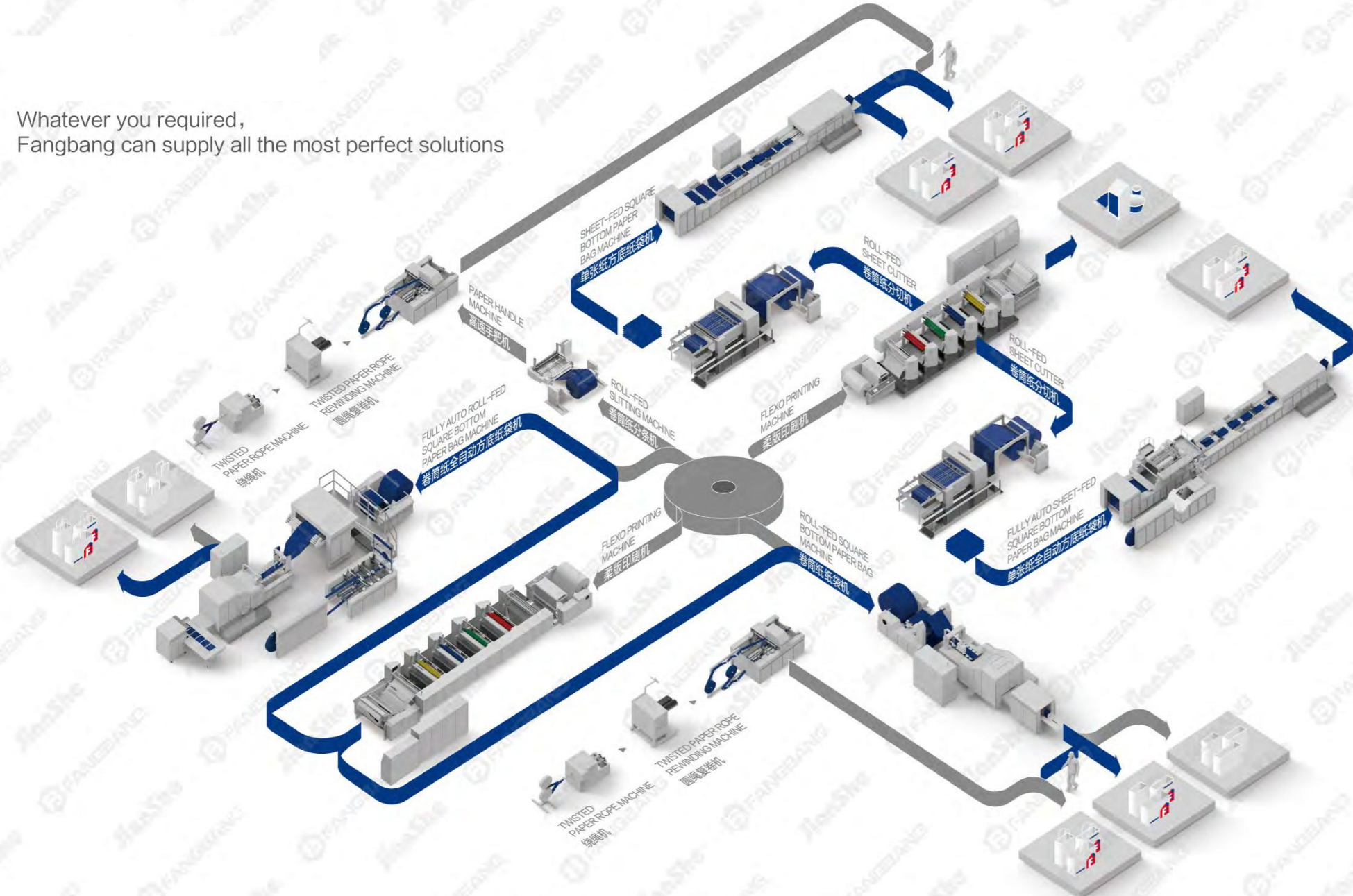

Categories	Sheet-fed Paper Bag Machine	Roll-fed Paper Bag Machine (Fully Auto)	Roll-fed Paper Bag Machine (Semi Auto)	Flexographic Printing Machine	Auxiliary Equipments
	03 ZD-QFP	19 ZD-QFB	35 ZD-J20S/D	53 YT-E ★	67 ZD-SB100
	Fully Auto Sheet-fed Square Bottom Paper Bag Machine	Fully Auto Roll-fed Square Bottom Paper Bag Machine with Flat Handle	Full-servo High Speed Flat Bottom Paper Bag Machine	High Speed Unit-type Flexo Printing Machine	High Speed Paper Handle Machine
	08 ZD-QFP08/14/18/18S/20 ★	22 ZD-QFB11/13E[S]/14/18C/21	37 ZD-J10/13	55 YT-D	69 ZD-YS300
	09 ZD-BFP	23 ZD-QFF14 ★	Roll-fed Flat Bottom Paper Bag Machine	Unit-type Flexo Printing Machine	Twisted Paper Rope Machine
	Auto Sheet-fed Square Bottom Paper Bag Machine	Dual-layer Fully Auto Roll-fed Square Bottom Paper Bag Machine with Flat Handle	39 ZD-FJ06	59 YT-CB ★	70 ZD-FJ200
	12 ZD-BFP08/18/20	25 ZD-QFJ	Fast Fixed-size Square Bottom Paper Bag Machine	Dual-servo Unit-type Flexo Printing Machine	Twisted Paper Rope Rewinding Machine
	13 ZD-FP	Fully Auto Roll-fed Square Bottom Paper Bag Machine	41 ZD-FJ	61 YT-BE	71 FQ-1400/1700/1900
	Sheet-fed Square Bottom Paper Bag Machine	30 ZD-QFJ08[T]/11E/13E[S]/14/18C/21	Roll-fed Square Bottom Paper Bag Machine	Stack-Type Flexo Printing Machine	Roll-fed Sheet Cutter
	16 ZD-FP08/14/18/20	31 ZD-QFJ18N ★	44 ZD-FJ08/11E/13E[S]/18B[C]/21	62 YT-BC	72 FT-1300/1800
		Fully Auto Roll-fed Square Bottom Paper Bag Machine (Full-servo)	45 ZD-FJ+T+D+W+P	Stack-Type Flexo Printing Machine	Roll-fed Slitting Machine
		Roll-fed Square Bottom Paper Bag Machine (Multi-functional Options)	47 ZD-FJ22+D/ZD-FJ05	63 YT-ZB	
		Fully Auto Roll-fed Square Bottom Paper Bag Machine (Fully Auto)	Roll-fed (Double Layers) Square Bottom Paper Bag Machine	Visual Plate Mounting Machine	
			49 ZD-FJ21+PE+S/ZD-FJ21+PC ★	64 YT-WQ	
			Roll-fed E-commerce Paper Bag Machine	Anilox Roller Ultrasonic Cleaning Machine	
Usage	Luxury Bags	FMCG Shopping Bags	Food Bags	Printing on Paper or Nonwoven Fabrics	Supporting Paper Bag Machines



# SHEET-FED PAPER BAG MACHINE

Applicable for **Luxury Bags**



They are all using the paper bags produced by our machines



And this, is only a small part of them



### ZD-QFP

Fully Auto Sheet-fed Square Bottom Paper Bag Machine



- Sheet Paper 单张纸
- Handle 自动带手把
- Punching 反折打孔
- Top Folding 反折带手把
- W/O Handle 无手把
- Roll Paper 筒状纸
- Patch Handle 贴手把

This machine is designed to manufacture small-sized square bottom paper bags with handles from sheet paper, paper patch roll and paper rope, and it is an ideal equipment for producing mid-to-high-end paper handbags, especially suitable for food, clothing and luxuries industries. By implementing steps including handle making, handle application, bag mouth folding, tube forming and bottom forming within a fully automatic process, this machine can effectively save labor costs. Equipped with advanced pre-heap paper feeder, this machine can realize non-stop feeding, thereby improving the production capacity. Thanks to perfect technologies, the machine can produce paper handbags with high quality in many different forms, thoroughly liberate the hands for making small-sized paper handbags, and bring more profit for the customer.

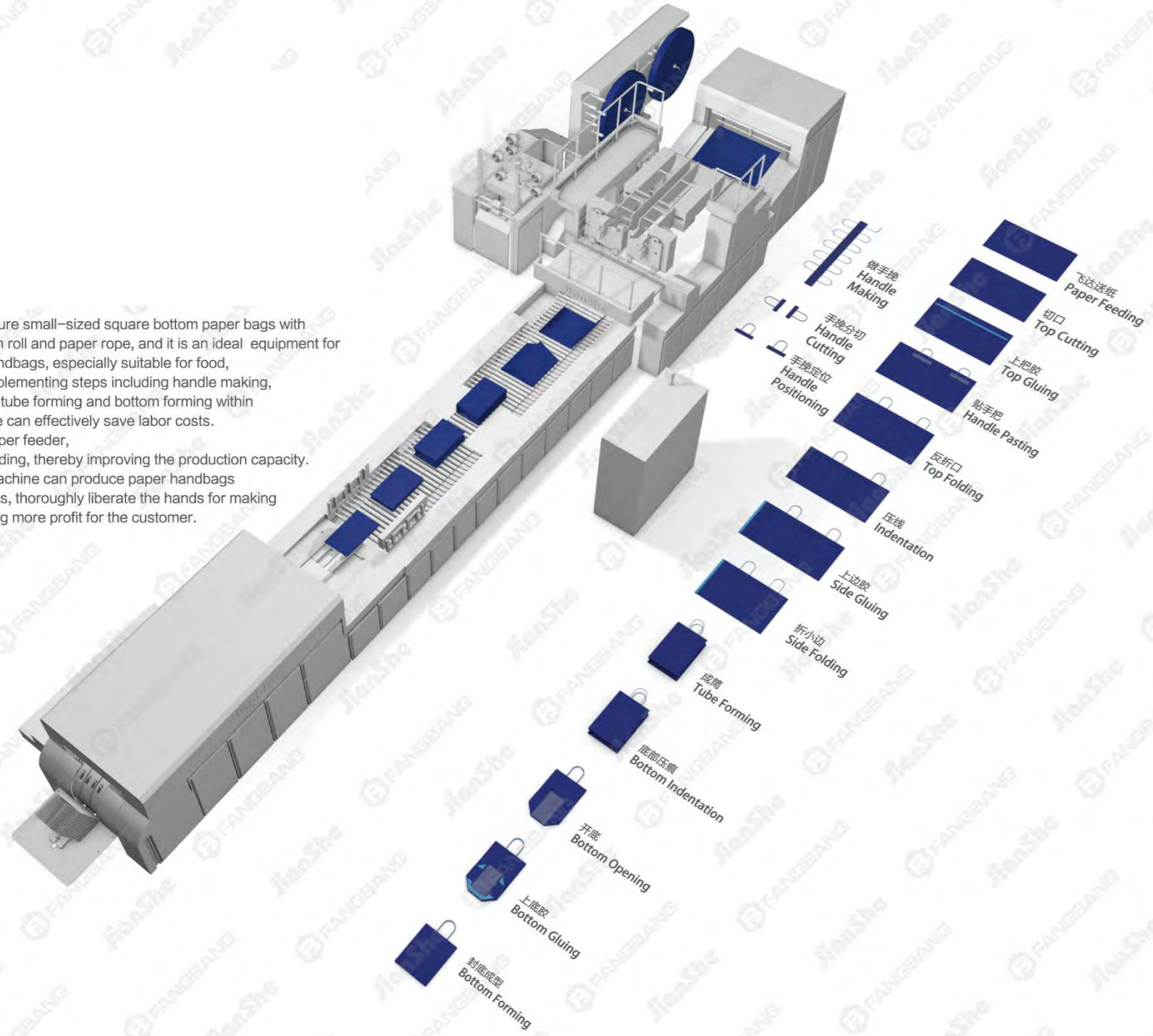

This machine can make 3 different kinds of paper bags, according to customers' various requirements, from various kinds of paper, including kraft paper, coated paper and laminated paper, etc.



Optional scissor clamp system and toggle clamp system, bring machines the advantage of coping with thin paper as well as thick paper (toggle clamp system can process some kind of paper with thickness 250gsm).



(scissor clamp system)

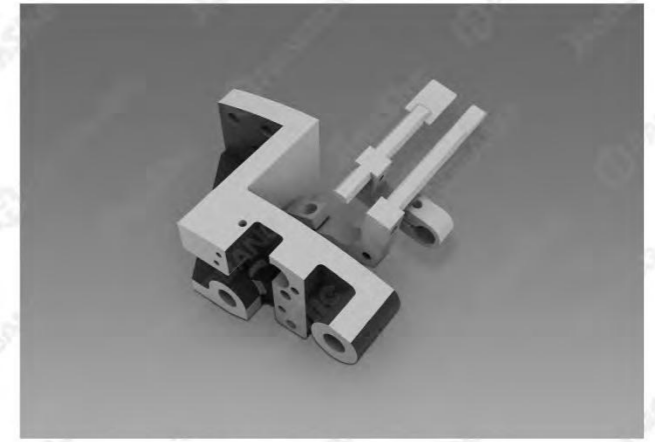

(toggle clamp system)

Optional transfer systems (belt-type and roller-type) for tube forming, meet requirements of different paper bag making processes for various kinds of paper.

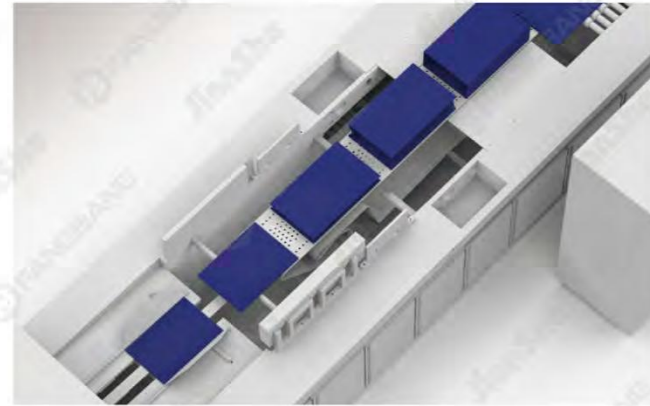

(belt-type transfer)

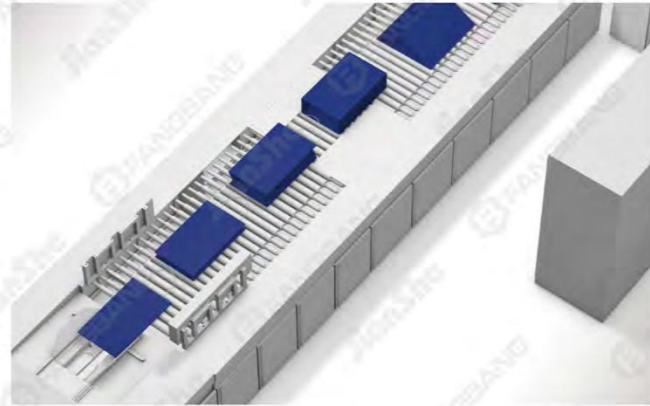

(roller-type transfer)

Special customized model design enlarges the production range of machines as well as the business range of customers (optional big/small side pasting device; bag width can reach 500mm or bottom size can reach 250mm).



Optional flat handle unit, brings more choices for bag making to customers and "non-creased" revolution to traditional shopping bag industry of Fast Moving Consumer Goods; optional servo motor, can replace traditional driving shaft, to efficiently reduce material waste and labor cost.



Can be equipped with creative Roll-fed Unwinding and Cutting Unit, which can help users to produce top-folded paper bags with handles from paper roll.



TECHNICAL DATA

	ZD-QFP08	ZD-QFP14	ZD-QFP18	ZD-QFP18S	ZD-QFP20
Paper Width	470~780mm	550~1050mm	630~1250mm	710~1250mm	710~1320mm
Paper Length	240~530mm	340~630mm	340~630mm	400~630mm	360~630mm
Paper Thickness	100~160g/m <sup>2</sup>	100~220g/m <sup>2</sup> (250g/m <sup>2</sup> )	100~220g/m <sup>2</sup> (250g/m <sup>2</sup> )	100~220g/m <sup>2</sup> (250g/m <sup>2</sup> )	100~220g/m <sup>2</sup> (250g/m <sup>2</sup> )
Bag Body Width	135~250mm	180~350mm	220~450mm	240~450mm	240~500mm
Bag Body Height	180~395mm	200~480mm	200~480mm	280~480mm	200~480mm
Bag Bottom Size	60~130mm	80~180mm	80~180mm/80~220mm	100~250mm	100~180mm
Bag Mouth Fold Width	35~55mm	40~60mm	40~60mm	40~60mm	40~60mm
Handle Rope Height	155~175mm	170~185mm	170~185mm	170~185mm	170~185mm
Handle Rope Diameter	Φ4~6mm	Φ4~6mm	Φ4~6mm	Φ4~6mm	Φ4~6mm
Handle Patch Length	114.3mm	152.4mm	188.5mm	188.5mm	188.5mm
Handle Patch Width	40~45mm	40~45mm	40~45mm	40~45mm	40~45mm
Paper Patch Roll Diameter	Φ1200mm	Φ1200mm	Φ1200mm	Φ1200mm	Φ1200mm
Paper Patch Roll Width	80~90mm	80~90mm	80~90mm	80~90mm	80~90mm
Paper Patch Thickness	100~250g/m <sup>2</sup>	100~250g/m <sup>2</sup>	100~250g/m <sup>2</sup>	100~250g/m <sup>2</sup>	100~250g/m <sup>2</sup>
Max. Speed	100bags/min	100bags/min	100bags/min	80bags/min	100bags/min
Total Power	35kw	35kw	35kw	35kw	35kw
Total Weight	Approx. 20000kg	Approx. 22000kg	Approx. 24000kg	Approx. 27000kg	Approx. 25000kg
Overall Dimension	L13500 × W4300 × H2400mm	L16000 × W4300 × H2600mm	L16000 × W4500 × H2600mm	L17500 × W4500 × H2600mm	L16000 × W4600 × H2600mm

Production speed will be variable due to different paper, glue and operator's skill.

### ZD-BFP

Auto Sheet-fed Square Bottom Paper Bag Machine

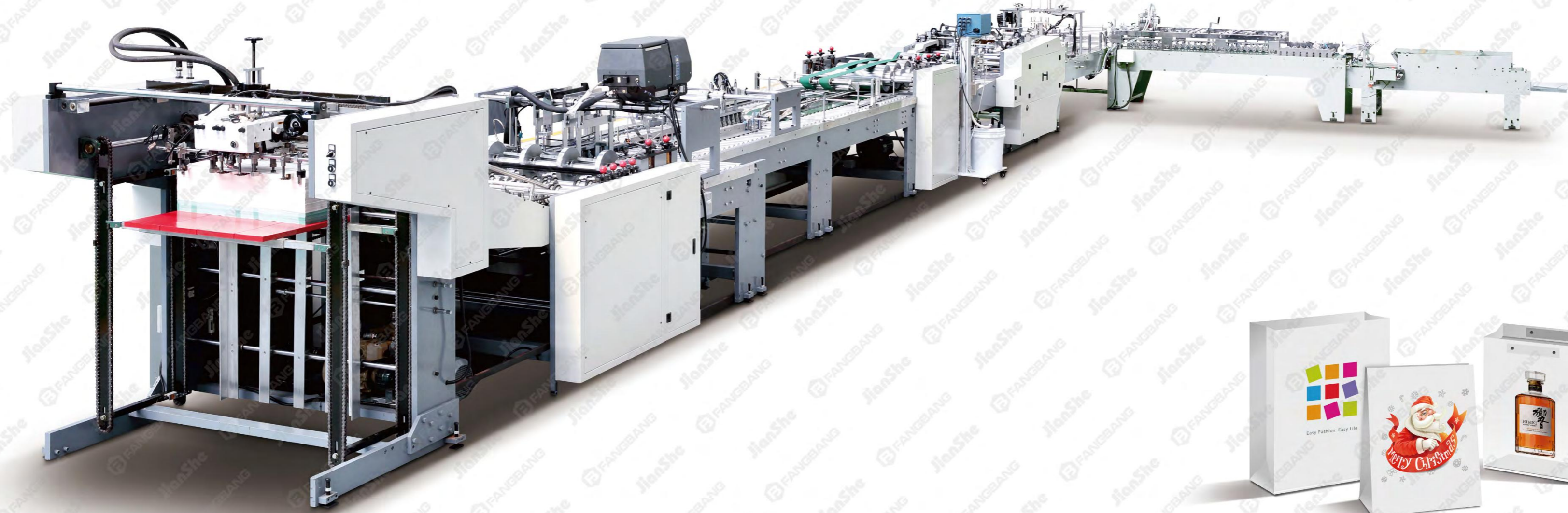

-  Sheet Paper  
单张纸
-  Punching  
反折打孔
-  W/O Handle  
无手把
-  Roll Paper  
卷筒纸
-  Patch Handle  
贴手把
-  Handle  
自动手把
-  Top Folding  
反折手把

This machine is designed to manufacture square bottom paper bags with top folding and bottom cardboard inserting from sheet paper, and it is an ideal equipment for processing mid-to-high-end trackless paper handbags. By implementing steps including paper feeding, line imposing, top folding, side gluing, tube forming, bag turnover, bottom forming, bottom cardboard inserting and bottom closing inline, this machine can effectively ensure high-quality paper bags as well as save labor costs. Equipped with advanced pre-heap paper feeder, this machine can realize non-stop feeding, thereby improving the production capacity. Special mechanical and electrical patented designs ensure that the machine can process various kinds of paper, thus being able to produce different excellent paper bags, which are especially suitable for food, clothing and luxuries industries.

Special patented design for top folding enables the machine to make 3 different kinds of bag mouths, so as to greatly enlarge business range of customers and bring more profits to customers.



Unconventional bottom cardboard inserting function can effectively strengthen weight capacity of paper bags and reduce labor cost of customers.



TECHNICAL DATA

	ZD-BFP08	ZD-BFP18	ZD-BFP20
Paper Width	390-780mm	550-1250mm	710-1320mm
Paper Length	310-530mm	310-630mm	340-630mm
Paper Thickness	A: 牛皮纸 120-200g/m <sup>2</sup> B: 铜版纸+PP覆膜 155-250g/m <sup>2</sup> C: 白卡+PP覆膜 180-250g/m <sup>2</sup> D: 灰板纸+PP覆膜 150-300g/m <sup>2</sup>	A: (Kraft Paper) 120-200g/m <sup>2</sup> B: (Art Paper)+(Laminated PP Film) 155-250g/m <sup>2</sup> C: (White Cardboard)+(Laminated PP Film) 180-250g/m <sup>2</sup> D: (Grey paperboard)+(Laminated PP Film) 150-300g/m <sup>2</sup>	
Bag Body Width	120-250mm	180-450mm	240-500mm
Bag Body Height	215-395mm	240-480mm	250-480mm
Bag Bottom Size	60-130mm	80-170mm	100-170mm
Bag Mouth Fold Width	25-50mm	25-50mm	25-50mm
Max. Speed	40-60bags/min	40-60bags/min	40-60bags/min
Total Power	12kw	15kw	15kw
Total Weight	10000kg	15000kg	15000kg
Overall Dimension	L17300 × W2200 × H1700mm	L17300 × W2500 × H1700mm	L17300 × W2600 × H1700mm
Overall Dimension of Bottom Card Device		L 2800 × W1500 × H1600mm	L2800 × W1500 × H1600mm

Production speed will be variable due to different paper, glue and operator's skill.

### ZD-FP

Sheet-fed Square Bottom Paper Bag Machine

- Sheet Paper  
单张纸
- Punching  
反折打孔
- W/O Handle  
无手把
- Roll Paper  
卷筒纸
- Patch Handle  
贴片手把
- Handle  
自动手把
- Top Folding  
反折顶手把



This machine is designed to manufacture square bottom paper bags without handles from sheet paper, and it is an ideal equipment for processing mid-to-high-end paper handbags. By implementing steps including paper feeding, line imposing, side gluing, tube forming and bottom forming inline, this machine can effectively ensure high-quality paper bags as well as save labor costs. Equipped with advanced pre-heap paper feeder, this machine can realize non-stop feeding, thereby improving the production capacity. Perfect water glue and hot-melt glue application devices ensure that the machine can process various kinds of paper, thus being able to produce different excellent paper bags, which are especially suitable for food, clothing and luxuries industries.

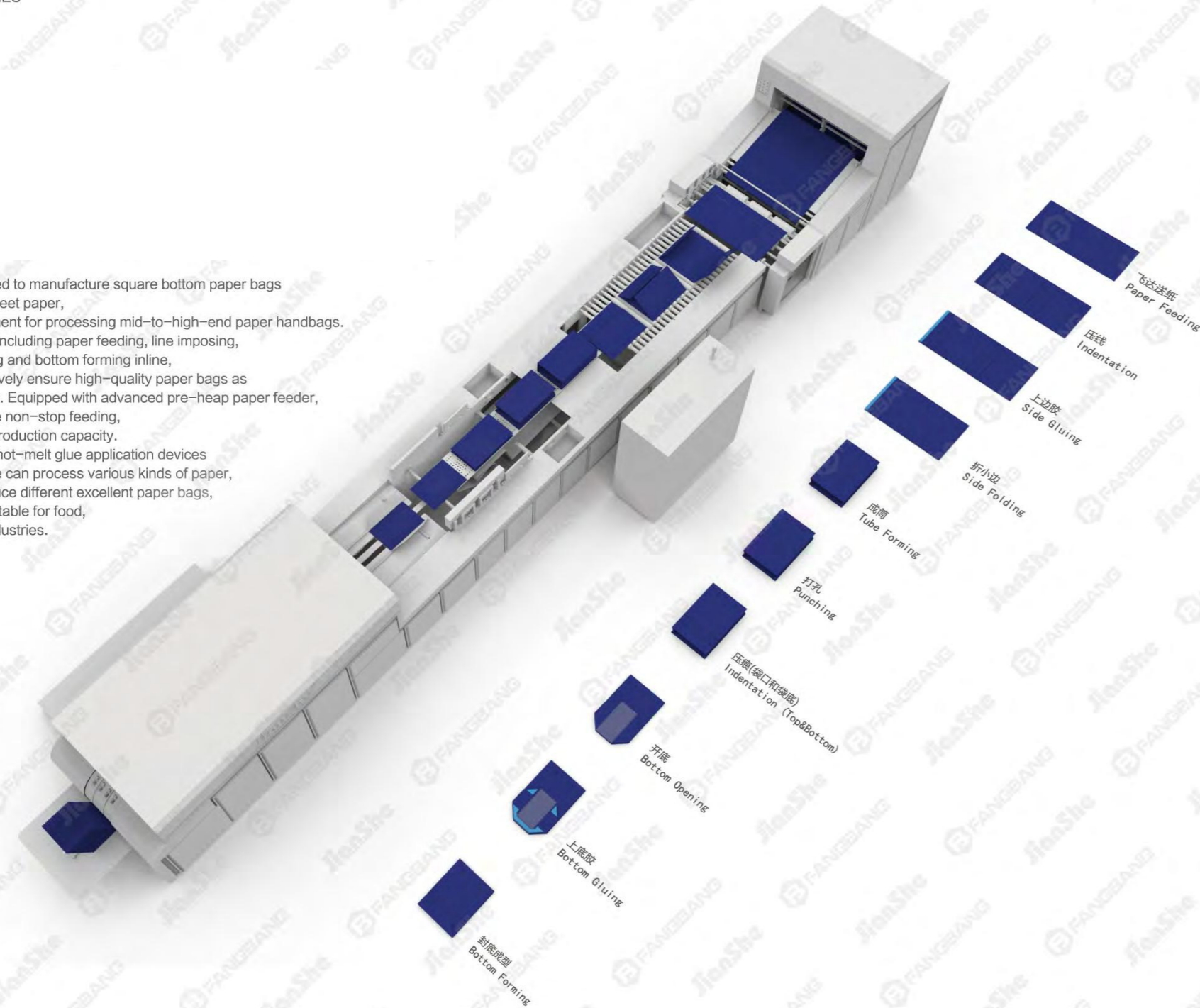

This machine can make 2 different kinds of paper bags without handles according to customers' various requirements.



The machine can process various kinds of paper, such as kraft paper, woodfree paper, coated paper and ivory board (including laminated paper), etc.



TECHNICAL DATA

	ZD-FP08	ZD-FP14	ZD-FP18	ZD-FP20
Paper Width	400~780mm	550~1050mm	630~1250mm	710~1320mm
Paper Length	310~530mm	340~630mm	340~630mm	360~630mm
Paper Thickness	100~160g/m <sup>2</sup>	100~250g/m <sup>2</sup>	100~250g/m <sup>2</sup>	100~250g/m <sup>2</sup>
Bag Body Width	120~250mm	180~350mm	220~450mm	240~500mm
Bag Body Height	215~395mm	200~480mm	200~480mm	200~480mm
Bag Bottom Size	60~130mm	80~180mm	80~180mm	100~180mm
Max. Speed	80bags/min	80bags/min	80bags/min	80bags/min
Total Power	12kw	13kw	15kw	15kw
Total Weight	Approx. 10000kg	Approx. 11000kg	Approx. 12000kg	Approx. 14000kg
Overall Dimension	L13500 × W2400 × H1600mm	L13000 × W2400 × H1700mm	L13000 × W2500 × H1700mm	L13500 × W2500 × H1700mm

Production speed will be variable due to different paper, glue and operator's skill.



# ROLL-FED PAPER BAG MACHINE (FULLY AUTO)

Applicable for FMCG Shopping Bags



They try best to chase the tide of this world



And the environmental paper bags from Fangbang, must lead the trend of future



### ZD-QFB

Fully Auto Roll-fed Square Bottom Paper Bag Machine with Flat Handle



This machine is designed to manufacture square bottom paper bags with flat-rope handles from paper roll, paper patch roll and flat handle paper roll, and it is an ideal equipment for producing paper handbags fast. By implementing steps including handle making, handle application, tube forming, tube cutting and bottom forming within a fully automatic process, this machine can effectively save labor costs. Distinct flat-rope handle making process and special bag counting function, greatly improve packing efficiency of finished paper bags. Thanks to perfect technologies and fast production speed, this machine can produce paper handbags with high quality in many different forms, which are especially suitable for food and clothing industries.

ZD-QFB14

The bottom forming hub of ZD-QFB14 makes 5 paper bags by 1 round, which brings apparently higher speed than other similar traditional models.



SIEMENS PLC system ensures that the adjustment of cutting length can be implemented directly on touch screen, meanwhile brings efficient and stable production.



By directly making flat-rope handles on paper web, customers can not only no longer rely on the traditional external hand making machine, but also be able to save 50% patch paper. Moreover, it can make folded or unfolded flat handle in the same machine, assisting users to balance traditional bag-using habit with highly effective packaging and transportation.



TECHNICAL DATA

	ZD-QFB11	ZD-QFB13E[S]	ZD-QFB14[S]	ZD-QFB18P	ZD-QFB21S[M]
Paper Roll Width	590~890mm(370~890mm)	590~990mm(400~990mm)	590~1150mm	630~1390mm(590~1390mm)	630~1530mm[690~1710mm]
Max. Paper Roll Diameter	Φ1500mm	Φ1500mm	Φ1500mm	Φ1500mm	Φ1500mm
Material Core Diameter	Φ76mm(3")	Φ76mm(3")	Φ76mm(3")	Φ76mm(3")	Φ76mm(3")
Paper Thickness	70~160g/m <sup>2</sup>	70~160g/m <sup>2</sup>	70~150g/m <sup>2</sup>	80~160g/m <sup>2</sup>	80~150g/m <sup>2</sup>
Bag Body Width	180~280mm(110~280mm)	200~330mm(125~330mm)	200~360mm	220~460mm(200~460mm)	220~540mm
Paper Tube Length	270~530mm	270~530mm	350~650mm	350~620mm(280~620mm)	400~720mm(380~770mm)
Bag Bottom Size	60~150mm	60~150mm[70~180mm]	80~200mm[100~230mm]	80~220mm	80~254mm[110~300mm]
Flat Handle Rope Height	75mm	75mm	75mm	90mm	90mm
Flat Handle Rope Width	10mm	13mm	13mm	16mm	16mm
Paper Rope Roll Width	78mm	101mm	101mm	93mm	93mm
Paper Rope Roll Diameter	Φ1200mm	Φ1200mm	Φ1200mm	Φ1200mm	Φ1200mm
Paper Rope Thickness	70~100g/m <sup>2</sup>	70~100g/m <sup>2</sup>	70~100g/m <sup>2</sup>	70~100g/m <sup>2</sup>	70~100g/m <sup>2</sup>
Handle Patch Length	160mm	160mm	160mm	170mm	170mm
Handle Patch Width	52mm	52mm	52mm	52mm	52mm
Paper Patch Roll Diameter	Φ1200mm	Φ1200mm	Φ1200mm	Φ1200mm	Φ1200mm
Paper Patch Roll Width	160mm	160mm	160mm	170mm	170mm
Paper Patch Thickness	70~110g/m <sup>2</sup>	70~110g/m <sup>2</sup>	70~110g/m <sup>2</sup>	70~110g/m <sup>2</sup>	70~110g/m <sup>2</sup>
Max. Speed	180bags/min(240bags/min)	180bags/min(220bags/min)	160bags/min	160bags/min(200bags/min)	120bags/min
Total Power	29kw	29kw	29kw	29kw	29kw[34kw]
Total Weight	Approx. 20000kg	Approx. 20000kg	Approx. 20000kg	Approx. 20000kg	Approx. 23000kg
Overall Dimension	L16000 × W3500 × H3500mm	L16000 × W3500 × H3500mm	L15000 × W3500 × H3500mm	L16000 × W3500 × 3500mm	L16000 × W3500 × H3500mm

Production speed will be variable due to different paper, glue and operator's skill.

## ZD-QFF14

Dual-layer Fully Auto Roll-fed Square Bottom Paper Bag Machine with Flat Handle

**NEW**

Global First  
Intelligent Operation



Distinct from traditional square bottom paper bag machine with flat handle, this machine is an ideal equipment for making high-level paper bag with flat handle. This machine is able to apply the flat handles made by a special device, onto one layer of paper or between double layers of papers, so as to get a special paper bag with flat handle but without patch paper. By implementing steps including handle making, handle application, tube forming, tube cutting and bottom forming within a fully automatic process, this machine can effectively save labor costs.

Special mechanical and electrical design makes this machine be able to produce various kinds of flat handle paper bags, which allows customers to switch freely between costs saving, mainstream market demand and bag load increasing.

### Technical Data 主要技术参数

### ZD-QFF14

Paper Roll Width	630~1150mm(590~1150mm)
Max.Paper Roll Diameter	Φ1200mm
Material Core Diameter	Φ76mm(3")
Paper Thickness	70~125g/m <sup>2</sup>
Bag Body Width	220~360mm(200~360mm)
Paper Tube Length	350~600mm(350~650mm)
Bag Bottom Size	80~200mm
Handle Center Distance	330mm ≤ a ≤ 560mm
Flat Handle Rope Height	80mm
Flat Handle Rope Width	18mm
Paper Rope Roll Width	80~85mm
Paper Rope Roll Diameter	Φ1000mm
Paper Rope Thickness	80~100g/m <sup>2</sup>
Handle Patch Length	180mm
Handle Patch Width	70mm
Paper Patch Roll Diameter	Φ1000mm
Paper Patch Roll Width	180mm
Paper Patch Thickness	80~100g/m <sup>2</sup>
Max. Speed	140bags/min
Total Power	56kw
Total Weight	Approx. 22000kg
Overall Dimension	L15000xW5500xH3600mm

Production speed will be variable due to different paper, glue and operator's skill.



- 1** Single-layer Paper + Flat Rope
- 2** Single-layer Paper + Flat Rope + Patch Paper
- 3** Dual-layer Paper + Flat Rope

### ZD-QFJ

Fully Auto Roll-fed Square Bottom Paper Bag Machine

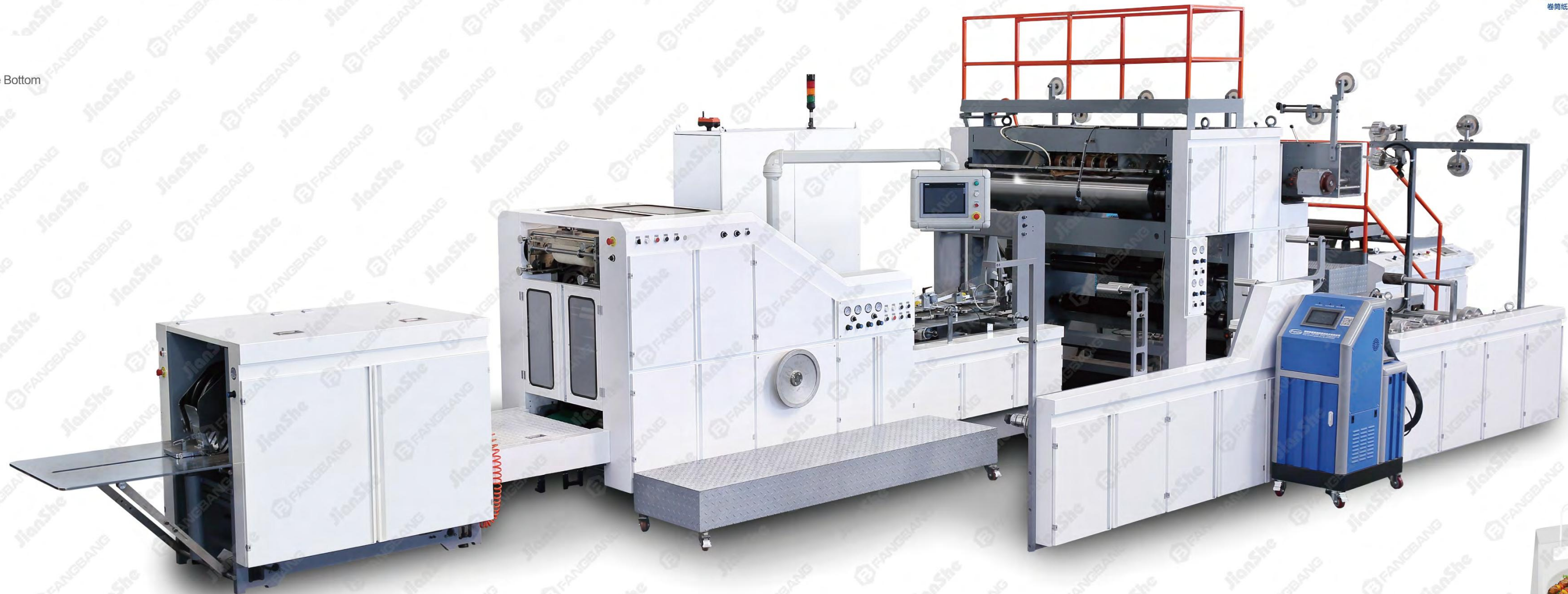

This machine is designed to manufacture square bottom paper bags with handles from paper roll, paper patch roll and paper rope, and it is an ideal equipment for producing paper handbags fast. By implementing steps including handle making, handle application, tube forming, tube cutting and bottom forming within a fully automatic process, this machine can effectively save labor costs. The equipped photoelectric detector can correct cutting length, so as to ensure cutting precision. SIEMENS PLC system and adjustable dual-moulds structure, ensure that the machine can perform quickly and stably, as well as reduce adjusting time for different bag sizes. Special bags collection platform and counting function, improve packing efficiency of finished paper bags. Thanks to perfect technologies and fast production speed, this machine can produce paper handbags with high quality in many different forms, which are especially suitable for food and clothing industries.

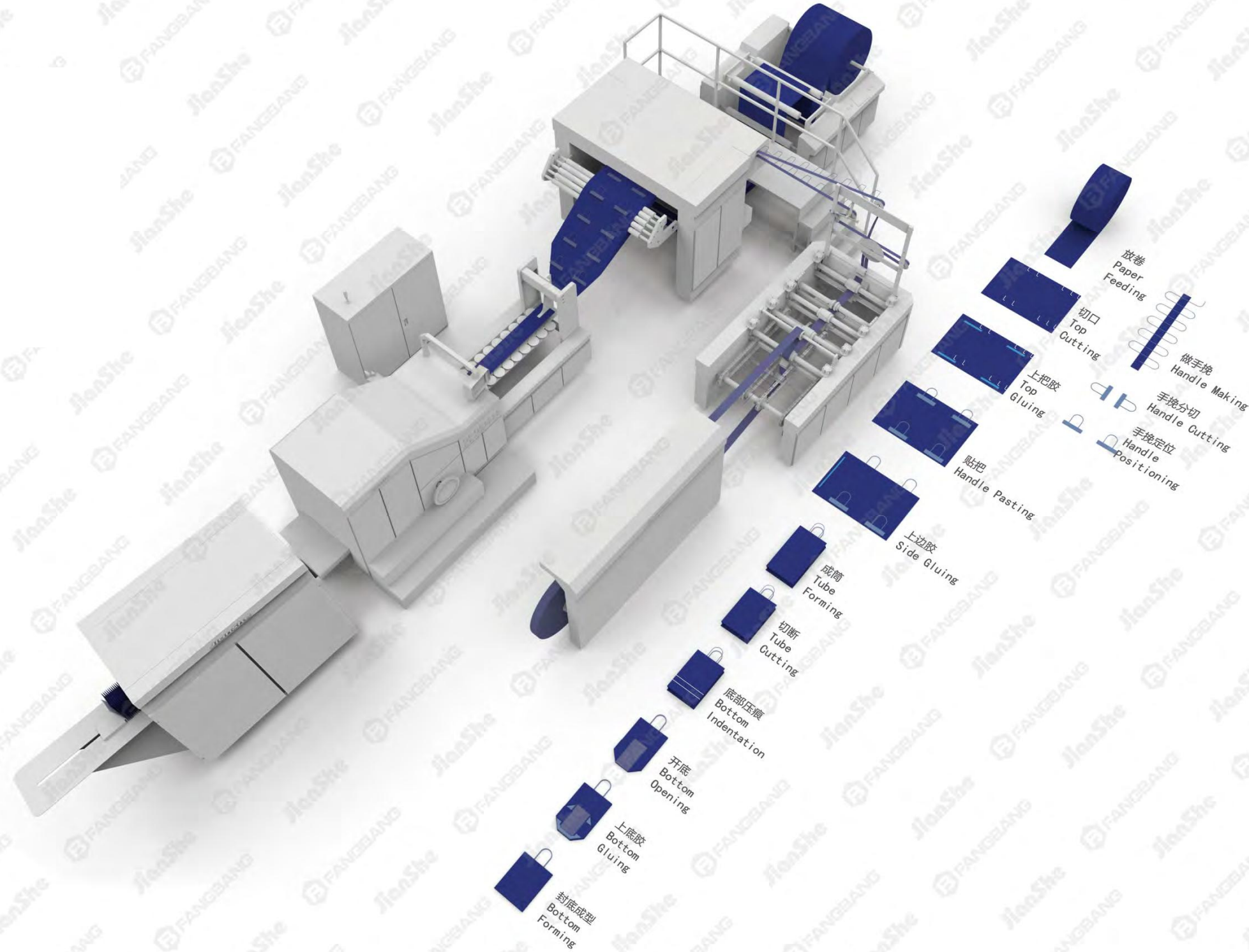

Special bottom closing device of ZD-QFJ08 improves the relatively slow bottom closing process in traditional models, so as to greatly enhance the bag making speed.

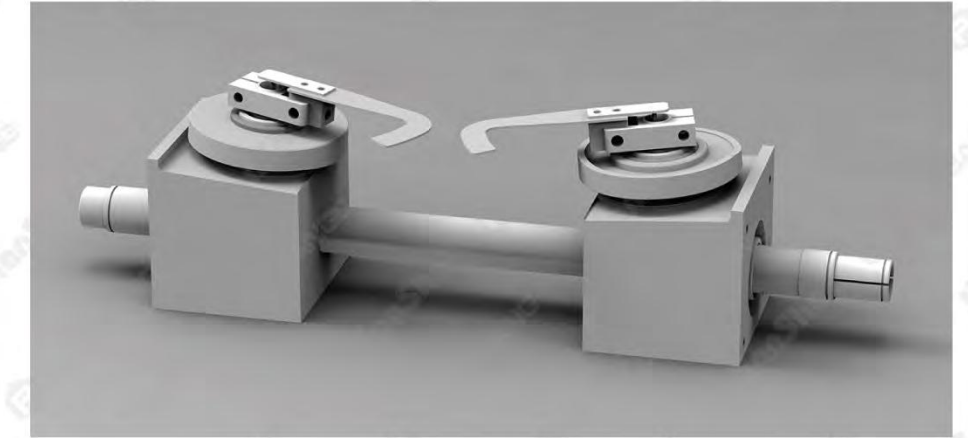

Distinct bottom gluing system (water glue) can efficiently save glue loss and labor cost, bringing the profit to the customer directly during the production.

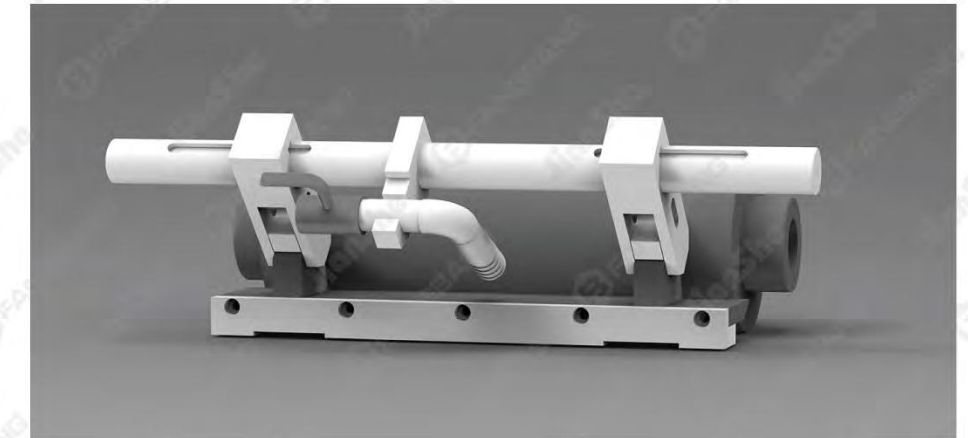

Tube cutter can be equipped with serrated blade or straight blade freely, J-cutting & top folding function can be optional so as to meet customers' requirements to different bag mouths.



This kind of machine can be connected with independent twisted handle machine and flat handle machine at the same time, so that users can not only save at least 40% investment and 45% space, but also be more flexible to paper bag market due to one-machine-two-usages.



The handle can be applied inside the paper bag for being a normal handbag; in the other mode the handle can also be applied outside the paper bag for being an Insulated Take-away Paper Handbag.



Our latest model ZD-QFJ21M, can efficiently produce square bottom paper handbag with gusset 300mm, which is suitable for carrying boxes for pizza, dessert and so on.



Adjustable dual-moulds structure (own proprietary technology) is applied on the machine, so that users can adjust bag size directly on the machine, which greatly reduces bag size adjusting time and increase production capacity.

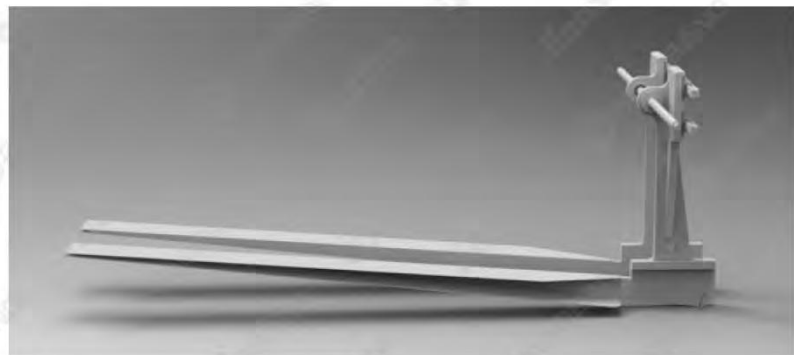

SIEMENS PLC system ensures that the adjustment of cutting length can be implemented directly on touch screen, meanwhile brings efficient and stable production.



TECHNICAL DATA

	ZD-QFJ08C[F]	ZD-QFJ08[N]	ZD-QFJ11E	ZD-QFJ13E[S]	ZD-QFJ14[S]	ZD-QFJ18P	ZD-QFJ21S[M]
Paper Roll Width	370~630mm	410~770mm[380~770mm]	590~890mm(370~890mm)	590~990mm(400~990mm)	590~1150mm	670~1390mm(590~1390mm)	630~1530mm[690~1710mm]
Max. Paper Roll Diameter	Φ1500mm	Φ1500mm	Φ1500mm	Φ1500mm	Φ1500mm	Φ1500mm	Φ1500mm
Material Core Diameter	Φ76mm(3")	Φ76mm(3")	Φ76mm(3")	Φ76mm(3")	Φ76mm(3")	Φ76mm(3")	Φ76mm(3")
Paper Thickness	45~140g/m <sup>2</sup>	50~140g/m <sup>2</sup>	50~150g/m <sup>2</sup>	80~160g/m <sup>2</sup>	80~150g/m <sup>2</sup>	70~160g/m <sup>2</sup>	80~170g/m <sup>2</sup>
Bag Body Width	120~200mm	140~220mm[120~220mm]	200~280mm(110~280mm)	200~330mm(125~330mm)	200~360mm	240~460mm(200~460mm)	220~540mm
Paper Tube Length	190~370mm[190~430mm]	215~370mm(215~470mm)	270~410mm(270~530mm)	270~420mm(270~530mm)	350~550mm(350~650mm)	350~520mm(280~620mm)	380~650mm(380~770mm)
Bag Bottom Size	50~100mm	50~140mm	60~150mm	60~150mm[70~180mm]	80~200mm[100~230mm]	80~220mm	80~254mm[110~300mm]
Handle Rope Height	90~95mm	80mm~85mm[90~95mm]	110~115mm	110~115mm	110~115mm	110~115mm	110~115mm
Handle Rope Diameter	Φ3~4mm	Φ4~6mm[Φ3~4mm]	Φ4~6mm	Φ4~Φ6mm	Φ4~Φ6mm	Φ4~6mm	Φ4~6mm
Handle Patch L. ength	96mm	114.3mm[96mm]	152.4mm	152.4mm	152.4mm	190.5mm	190.5mm
Handle Patch Width	45~50mm	45~50mm	45~50mm	45~50mm	45~50mm	45~50mm	45~50mm
Paper Patch Roll Diameter	Φ1200mm	Φ1200mm	Φ1200mm	Φ1200mm	Φ1200mm	Φ1200mm	Φ1200mm
Paper Patch Roll Width	90~100mm	90~100mm	90~100mm	90~100mm	90~100mm	90~100mm	90~100mm
Paper Patch Thickness	100~180g/m <sup>2</sup>	100~180g/m <sup>2</sup>	100~180g/m <sup>2</sup>	100~180g/m <sup>2</sup>	100~180g/m <sup>2</sup>	100~180g/m <sup>2</sup>	100~180g/m <sup>2</sup>
Max. Speed	200bags/min(220bags/min)	200bags/min(220bags/min)	180bags/min(220bags/min)	180bags/min(220bags/min)	160bags/min(150bags/min)	180bags/min(180bags/min)	110bags/min(120bags/min)
Total Power	28kw	28kw	38kw	38kw	39kw	38kw	39kw[44kw]
Total Weight	Approx.15000kg	Approx. 15000kg	Approx. 18000kg	Approx.18000kg	Approx. 20000kg	Approx. 20000kg	Approx. 23000kg
Overall Dimension	L11000 × W4400 × H1800mm	L11000 × W4400 × H1800mm	L14000 × W6000 × H3400mm	L14000 × W6000 × H3400mm	L14000 × W6000 × H3400mm	L14500 × W6000 × H3400mm	L14000 × W6000 × H3400mm

Production speed will be variable due to different paper, glue and operator's skill.

## ZD-QFJ18N

Fully Auto Roll-fed Square Bottom Paper Bag Machine (Full-servo)

**NEW**

Global First  
Size-change 10mins

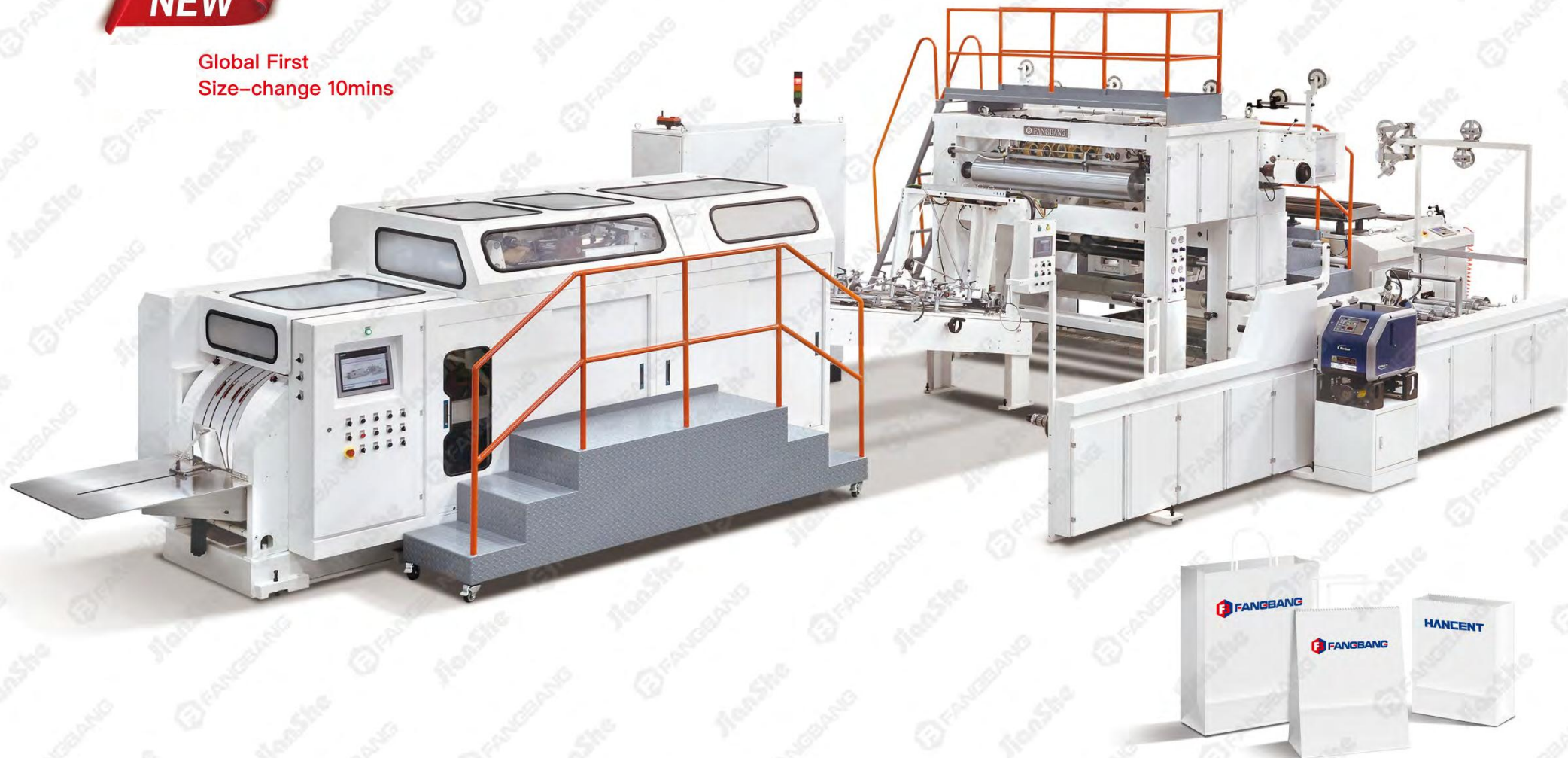

This machine is designed to manufacture square bottom paper bags with handles from paper roll, and it is an ideal equipment for producing mid-size and big-size paper bags fast. By implementing steps including paper feeding, tube forming, tube cutting and bottom forming inline, this machine can effectively save labor costs.

### Technical Data 主要技术参数

ZD-QFJ18N	
Paper Roll Width	550-1390mm(490~1390mm)
Max.Paper Roll Diameter	Φ1500mm
Material Core Diameter	Φ76mm(3")
Paper Thickness	80~150g/m <sup>2</sup>
Bag Body Width	180~460mm(150mm~460mm) <sub>min max</sub>
Paper Tube Length	300~570mm(280~590mm)
Bag Bottom Size	80~220mm
Handle Rope Height	110mm~115mm
Handle Rope Diameter	Φ4~6mm
Handle Patch Length	152.4mm
Handle Patch Width	45~50mm
Paper Patch Roll Diameter	Φ1200mm
Paper Patch Roll Width	90~100mm
Paper Patch Thickness	100~180g/m <sup>2</sup>
Max. Speed	150bags/min(180bags/min)
Total Power	46kw
Total Weight	Approx. 21000kg
Overall Dimension	L14500xW6000xH3400mm

Production speed will be variable due to different paper, glue and operator's skill.

Adopting fully servo motor driven equipment, reducing the steps of mechanical gear replacement and manual adjustment, Digitally and intelligently control the cutting length, and can preset the paper bag size and bag making formula. It reduces the adjustment time and improves production efficiency, it's an ideal equipment for producing handbags.



This kind of machine can be connected with independent twisted handle machine and flat handle machine all the same time, and inlaid flat handle as well. So that users can not only save at least 40% investment and 45% space, but also be more flexible to paper bag market due to one-machine-two-usages.





# ROLL-FED PAPER BAG MACHINE (SEMI AUTO)

Applicable for Food Bags



You use our paper bags every day



Because, all the best comes from healthy life



### ZD-J20S/D

Full-servo High Speed Flat Bottom Paper Bag Machine



As the first genuine Full-servo Flat Bottom Paper Bag Machine in China, this machine can make use of 9 high-speed and high-precision servo motors, to complete processes including paper unwinding, hot-melt glue spraying, film pasting, perforation, side gluing, tube forming, tube breaking, bottom gluing, bottom forming and bags collection at high speed. It produces flat & satchel paper bags not only for food industry, but also for medicine industry and other fast-consuming industries. Thanks to the special dual-line production design, this machine is an ideal alternative to imported equipment, for customers to find the perfect balance between production efficiency and bag size according to their various requirements.

#### Technical Data

	ZD-J20S (单线 Single Line)	ZD-J20D (双线 Dual Lines)
Max. Paper Roll Width	1100mm	1100mm
Max. Paper Roll Diameter	φ1300mm	φ1300mm
Material Core Diameter	φ76mm (3")	φ76mm (3")
Material Thickness	Paper: 30~90g/m <sup>2</sup> Cellophane: 40~90g/m <sup>2</sup>	Paper: 30~90g/m <sup>2</sup> Cellophane: 40~90g/m <sup>2</sup>
Tube Length	105~400mm	105~400mm
Bag Body Width	W/O Gusset: 60~500mm With Gusset: 60~500mm	W/O Gusset: 60~230mm With Gusset: 60~190mm
Max. Gusset Depth	65mm	65mm
Bottom Folding Length	15~25mm	15~25mm
Max. Speed	1000bags/min	1800bags/min
Total Power	75kw	75kw
Total Weight	Approx. 5000kg	Approx. 5000kg
Overall Dimension	L9000mm × W2500mm × H2100mm	L9000mm × W2500mm × H2100mm

Production speed will be variable due to different paper, glue and operator's skill.



As initiated inside China, the special designed vacuum forming mould ensures stable tube forming for thin paper at extremely high speed, which provides a strong guarantee for fast and stable flat & satchel paper bag making.



9 Siemens servo motors work synchronously at high speed and high precision, to ensure the capability of fast and stable dual-lane production, bringing customers more than 4 times as the output of traditional similar models.

### ZD-J

Roll-fed Flat Bottom Paper Bag Machine



This machine is designed to manufacture sharp bottom paper bag from paper roll, and it is suitable for kraft paper, ribbed kraft paper, grease-proof paper, coated paper, medico paper & etc. By implementing steps including roll feeding, side gluing, perforating, tube forming, tube cutting off, bottom folding and gluing, finished bag collecting within a fully automatic process, can effectively save labor costs. It has advantage of easy operation, high efficiency, more steady, it is an ideal machine for make different kind of paper bag, snack paper bag, food paper bag, bread paper bag, dry fruit paper bag and eco-friendly paper bag.

1. Machine use French Schneider touch screen human-computer interface, operation and control easily.
2. Adopt UK TRIO PC micro-computer control system, integrated with optical fiber, ensure high speed running steadily.
3. Adopt Japanese Yaskawa Servo Control System and German SICK photocell for rectify, tracking printed bag accurately.
4. Optional window making device including film unwinder and hot-melt glue system, can apply transparent window on one face of paper bag to display more clearly the goods inside.
5. Optional printing unit without unwinding/rewinding, saves operation time and physical space greatly, bringing more automation into traditional paper bag production.

#### TECHNICAL DATA

	ZD-J10	ZD-J13
Paper Roll Width	170~780mm	170~900mm
Max. Paper Roll Diameter	Φ1000mm	Φ1000mm
Paper Core Diameter	Φ76mm(3")	Φ76mm(3")
Paper Thickness	35~80g/m <sup>2</sup>	35~80g/m <sup>2</sup>
Bag Body Length	100~450mm	120~710mm
Bag Body Width	80~250mm	80~320mm
Gusset Size	0~130mm	0~130mm
Film Width	50~200mm	50~200mm
Film Thickness	12~50um	12~50um
Film Core Diameter	Φ76mm(3")	Φ76mm(3")
Max. Speed	500bags/min	500bags/min
Total Power	21kw	21kw
Total Weight	Approx. 4500kg	Approx. 6500kg
Overall Dimension	7000X1800X1900mm	7600X2200X2100mm

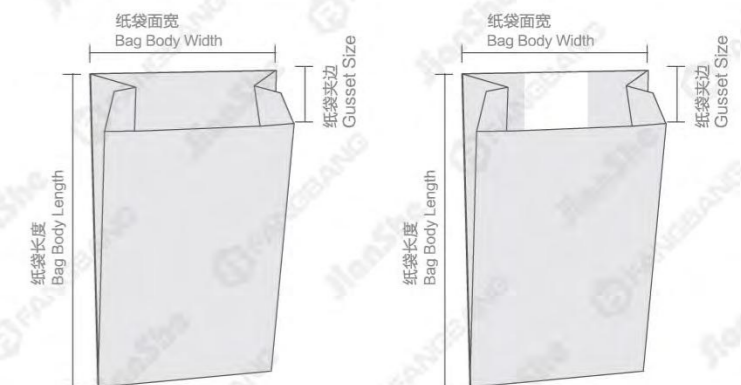

Production speed will be variable due to different paper, glue and operator's skill.

### ZD-FJ06

Fast Fixed-size Square Bottom Paper Bag Machine



As designed to produce square bottom paper bags without handles from roll paper, this machine is an ideal equipment for producing small fixed-size paper bags in extremely fast speed. This machine can implement steps including paper feeding, tube forming, tube cutting and bottom forming inline in incredible speed, so as to effectively save labor costs. The equipped photoelectric detector can correct cutting length automatically, so as to ensure cutting precision. The equipped SIEMENS PLC system ensures that the stable performance can be kept even if the machine is running in various working environments. This machine can process very thin paper, as well as produce paper bags exceedingly fast, thus this machine is especially suitable for being applied in massive productions of food industries.

#### TECHNICAL DATA

	ZD-FJ06
Paper Roll Width	535mm
Max. Paper Roll Diameter	Φ1200mm
Material Core Diameter	Φ76mm(3")
Paper Thickness	55~70g/m <sup>2</sup>
Tube Length	380mm
Bag Body Width	154mm
Bag Bottom Size	100mm
Max. Speed	500bags/min
Total Power	8.4kw
Total Weight	Approx. 5500kg
Overall Dimension	L7500 × W2250 × H1800mm

This machine can produce paper bags in extremely fast speed (500 pcs/min at MAX.).



This machine can process thin paper for paper bags (paper thickness: 55~70g/m<sup>2</sup>).



### ZD-FJ

Roll-fed Square Bottom Paper Bag Machine



This machine is designed to manufacture square bottom paper bags without handles from paper roll, and it is an ideal equipment for producing producing various sized paper bags fast. By implementing steps including paper feeding, tube forming, tube cutting and bottom forming inline, this machine can effectively save labor costs. The equipped photoelectric detector can correct cutting length, so as to ensure cutting precision. The equipped SIEMENS PLC system ensures that the machine can perform quickly and stably. This machine can process very thin paper, as well as produce paper bags very fast, thus this machine is especially suitable for being applied in food industries.

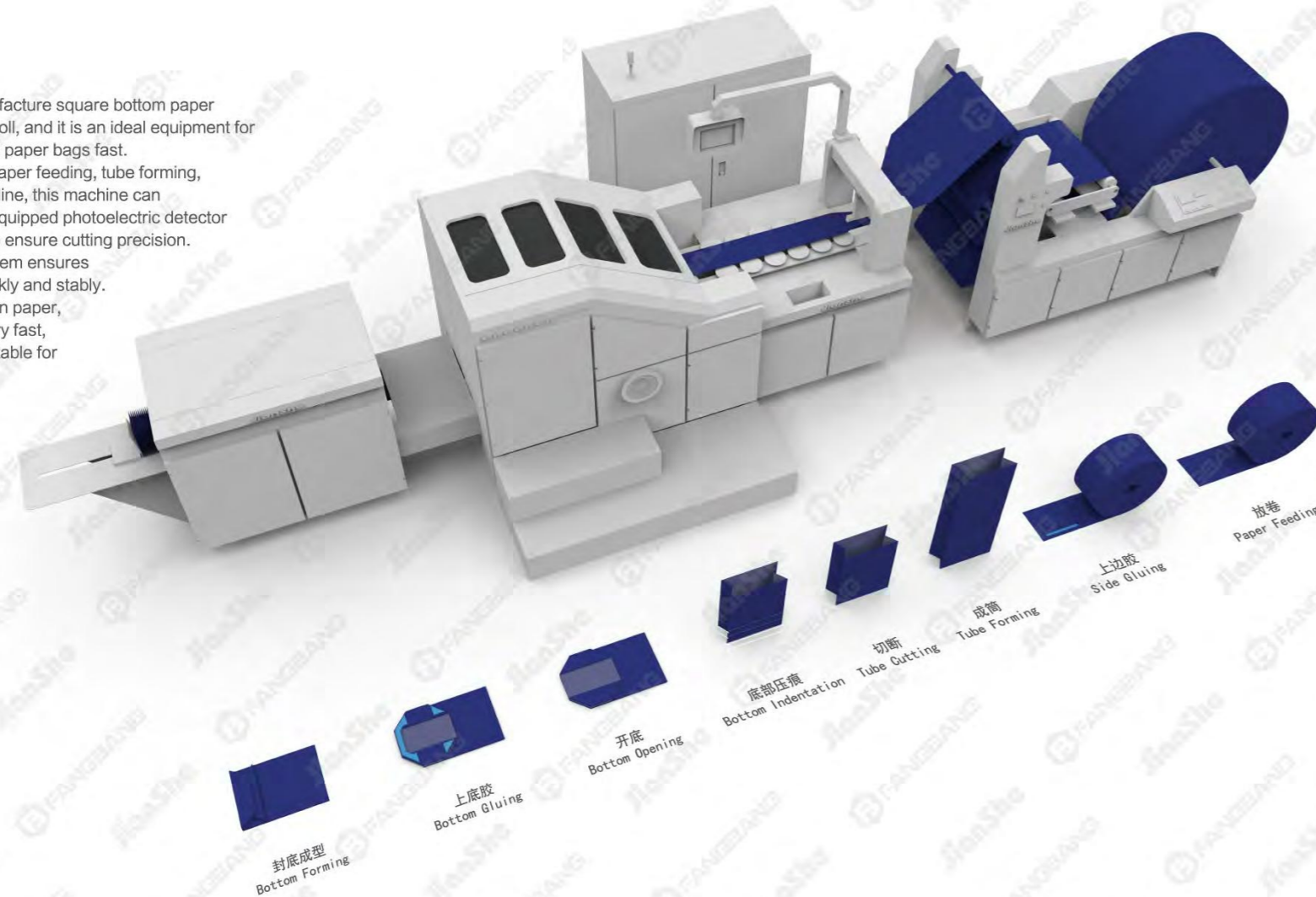

This machine can produce paper bags of wide-range sizes. It can produce not only small-size food bags, but also big-size shopping bags.



This machine can make various kinds of paper bags with different bottom styles.



TECHNICAL DATA

	ZD-FJ05	ZD-FJ08	ZD-FJ11E	ZD-FJ13E[S]	ZD-FJ14[S]	ZD-FJ18P[C]	ZD-FJ21S[M]
Paper Roll Width	200~450mm	290~630mm	370~890mm	400~990mm[420~1050mm]	590~1150mm	590~1390mm [650~1280mm]	630~1530mm[690~1710mm]
Max. Paper Roll Diameter	Φ1000mm	Φ1200mm	Φ1500mm	Φ1500mm	Φ1500mm	Φ1500mm	Φ1500mm
Material Core Diameter	Φ76mm(3")	Φ76mm(3")	Φ76mm(3")	Φ76mm(3")	Φ76mm(3")	Φ76mm(3")	Φ76mm(3")
Paper Thickness	45~100g/m <sup>2</sup>	45~130g/m <sup>2</sup>	50~150g/m <sup>2</sup>	55~160g/m <sup>2</sup>	80~150g/m <sup>2</sup>	70~160g/m <sup>2</sup>	80~170g/m <sup>2</sup>
Tube Length	120~345mm	190~370mm	270~530mm	270~530mm	340~650mm	280~620mm[380~760mm]	380~770mm
Bag Body Width	55~125mm	80~200mm	110~280mm	125~330mm	200~360mm	200~460mm[220~450mm]	220~540mm
Bag Bottom Size	30~80mm	50~100mm	60~150mm	60~150mm[70~180mm]	80~200mm[100~230mm]	80~220mm[90~180mm]	80~254mm[110~300mm]
Max. Speed	200bags/min	260bags/min	240bags/min	220bags/min	150bags/min	180bags/min	120bags/min
Total Power	12kw	13.5kw	16kw	16kw [19kw]	18.5kw	18.5kw	18.5kw [23.5kw]
Total Weight	Approx.5500kg	Approx. 6000kg	Approx. 8000kg	Approx. 8500kg	Approx. 11000kg	Approx. 11000kg	Approx. 14000kg
Overall Dimension	L8000xW3000xH1600mm	L8500xW3000xH1600mm	L10000xW3300xH2000mm	L10000xW3450xH2000mm	L10500xW3500xH2000mm	L12000xW3500xH2000mm	L11600xW3500xH2000mm

Production speed will be variable due to different paper, glue and operator's skill.

### ZD-FJ+T+D+W+P

Roll-fed Square Bottom Paper Bag Machine  
(Multi-functional Options)

By additionally embed functional unit (flexo printing, dual-layer pasting, die-cut window making or patching & punching) between the unwinding unit and tube forming unit in traditional paper bag machine, this kind of machine realizes the seamless connection between bag making and additional process, so as to effectively reduce equipment investment and save labor costs, meanwhile make the customer be more flexible to the rapidly changing market by upgrading machine functions.

As a functional extension of traditional model of paper bag machine, this kind of machine can make paper bags without handles inline from paper roll, thus it is an ideal equipment for producing printed paper bags fast. This kind of machine can produce paper bags of varying greatly sizes at a high speed, thus it is especially suitable for being applied in food and clothing industries.



+P  
Patching & punching unit

+W  
Die cutting & film patching unit

+D  
Double layers unit

+T  
Printina unit



## ZD-FJ22+D

Roll-fed (Double Layers)  
Square Bottom Paper Bag Machine

# SUPER BIG (Double Layers)



### Technical Data

ZD-FJ22+D

Paper Roll Width	770-1700mm
Max. Paper Roll Diameter	Φ1200mm
Material Core Diameter	Φ76mm (3")
Paper Thickness	70-125g/m <sup>2</sup>
Tube Length	600-1180mm
Bag Body Width	220-540mm
Bag Bottom Size	80-350mm
Max. Speed	100bags/min
Total Power	25.5kw
Total Weight	Approx. 18000kg
Dimension(L*W*H mm)	L16000 × W3500 × H2300mm

This machine is designed to manufacture square bottom paper bags without handles by single layer or double layers paper, from paper roll, and it is an ideal equipment for producing medium size and super big paper bag.

解决塑料制品对环境生态二次破坏的痛点。

Replacing plastic bags to deal with fallen leaves and other garbage waste, solving the pain points of secondary damage to the environment and ecology caused by plastic products. Effectively reducing the labor cost of long-term manual production. The double-layer bag making function increases the firmness of the bag.

生产速度会因纸张和胶水的品质，以及操作人员操作熟练程度而有所不同。  
Production speed will be variable due to different paper, glue and operator's skill.

## ZD-FJ05

Roll-fed  
Square Bottom Paper Bag Machine

# SUPER MINI



### Technical Data

ZD-FJ05

Paper Roll Width	200-450mm
Max. Paper Roll Diameter	Φ1000mm
Material Core Diameter	Φ76mm (3")
Paper Thickness	45-100g/m <sup>2</sup>
Tube Length	130-350mm
Bag Body Width	55-125mm
Bag Bottom Size	30-80mm
Max. Speed	200bags/min
Total Power	12kw
Total Weight	Approx. 5500kg
Dimension(L*W*H mm)	L8000 × W3000 × H1600mm

This machine is designed to manufacture square bottom paper bags without handles from paper roll, and it is an ideal equipment for producing producing various sized paper bags fast. By implementing steps including paper feeding, tube forming, tube cutting and bottom forming inline, this machine can effectively save labor costs. The equipped photoelectric detector can correct cutting length, so as to ensure cutting precision. The equipped SIEMENS PLC system ensures that the machine can perform quickly and stably. This machine can process very thin paper, as well as produce paper bags very fast, thus this machine is especially suitable for being applied in food industries, such as mini bags for sugar, flour, coffee, tea, portable knife & fork.

生产速度会因纸张和胶水的品质，以及操作人员操作熟练程度而有所不同。  
Production speed will be variable due to different paper, glue and operator's skill.

### ZD-FJ21+PE+S

Roll-fed E-commerce Paper Bag Machine

**NEW**

**Global First  
Multiple Functions**



This machine derives from the traditional roll-fed paper bag machine by adding special function, which makes itself be able to make special e-commerce paper bags for shipping light merchandise. This machine is multi-function and easy-operation, and it can efficiently and stably implement processes including flap die-cut, bottom forming and peel&seal strip/tear strip pasting, which can save the labor cost markedly and create more values for customers.



#### TECHNICAL DATA

V-bottom with Flap    Square Bottom with Flap    Cross Bottom with Flap    Square Bottom w/o Flap

	V-bottom with Flap	Square Bottom with Flap	Cross Bottom with Flap	Square Bottom w/o Flap
Paper Roll Width	630~1530mm	630~1530mm	630~1110mm	630~1530mm
Max. Paper Roll Diameter	Φ1500mm	Φ1500mm	Φ1500mm	Φ1500mm
Material Core Diameter	Φ76mm (3")	Φ76mm (3")	Φ76mm (3")	Φ76mm(3")
Paper Thickness	80~130g/m <sup>2</sup>	80~130g/m <sup>2</sup>	80~130g/m <sup>2</sup>	80~170g/m <sup>2</sup>
Tube Length	380~770mm	380~770mm	380~770mm	380~770mm
Bag Body Width	220~540mm	220~540mm	300~540mm	220~540mm
Bag Bottom Size	/	80~210mm	80~110mm	80~210mm
Gusset Size	0, 40~130mm	80~210mm	/	80~210mm
Flap Height	50~120mm	50~130mm	50~120mm	/
Max. Speed	100bags/min	100bags/min	100bags/min	120bags/min
Total Power	52.5kw	52.5kw	52.5kw	52.5kw
Total Weight	Approx. 16000kg	Approx. 16000kg	Approx. 16000kg	Approx. 16000kg
Dimension(L*W*H mm)	14000 × 7000 × 2000mm	14000 × 7000 × 2000mm	14000 × 7000 × 2000mm	14000 × 7000 × 2000mm

Various Kinds of Bag Flap    Various Kinds of Bag Bottom

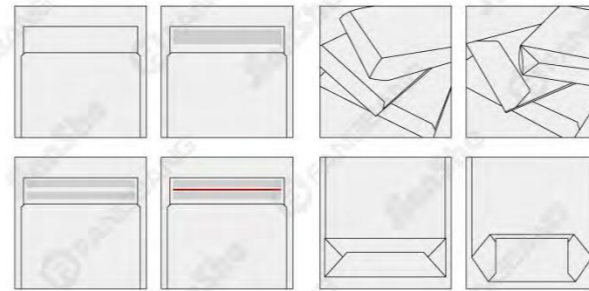

### ZD-FJ21+PC

Roll-fed E-commerce Paper Bag Machine

**NEW**

**Global First  
Low-cost & High-profit**



This machine derives from the traditional roll-fed paper bag machine by adding special function, which makes itself be able to make special e-commerce paper bags for shipping light merchandise. This machine is multi-function and easy-operation, and it can efficiently and stably implement processes including flap forming, bottom forming and peel&seal strip/tear strip pasting, which can save the labor cost markedly and create more values for customers.

#### TECHNICAL DATA

Square Bottom with Flap    Cross Bottom with Flap    Square Bottom w/o Flap

	Square Bottom with Flap	Cross Bottom with Flap	Square Bottom w/o Flap
Paper Roll Width	630~1530mm	630~1110mm	630~1530mm
Max. Paper Roll Diameter	Φ1500mm	Φ1500mm	Φ1500mm
Material Core Diameter	Φ76mm (3")	Φ76mm(3")	Φ76mm (3")
Paper Thickness	80~130g/m <sup>2</sup>	80~130g/m <sup>2</sup>	80~170g/m <sup>2</sup>
Tube Length	420~720mm	420~720mm	420~720mm
Bag Body Width	220~540mm	300~540mm	220~540mm
Bag Bottom Size	80~210mm	80,90,100,110mm	80~210mm
Flap Height	customized	customized	/
Max. Speed	120bags/min	120bags/min	120bags/min
Total Power	64kw	64kw	64kw
Total Weight	18000kg	18000kg	18000kg
Dimension(L*W*H mm)	17000 × 7000 × 2000mm	17000 × 7000 × 2000mm	17000 × 7000 × 2000mm

Various Kinds of Bag Flap    Various Kinds of Bag Bottom

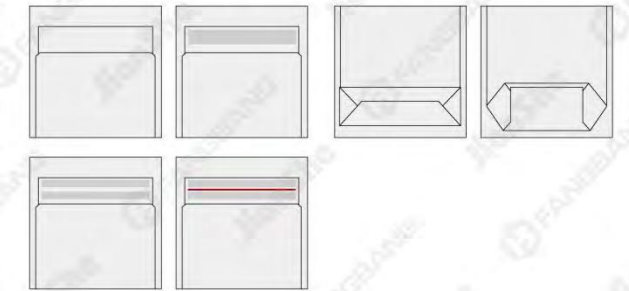



## FLEXOGRAPHIC PRINTING MACHINE

适用于纸张、无纺布印刷

Applicable for Printing on Paper or Nonwoven Fabrics



Inadvertently, you will find products from our machines



This, is the charm of flexographic printing machine



YT-E

High Speed  
Unit-type Flexo Printing Machine

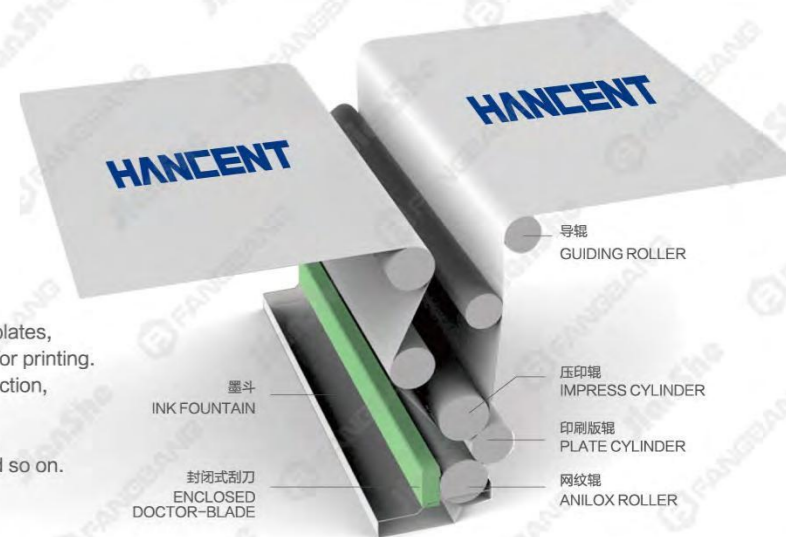

This machine is a printing machine which adopts flexible photosensitive resin plates, rubber plates as the base material, anilox rollers for transferring ink, liquid ink for printing. It is controlled centrally by PLC system and generally consists of unwinding section, tension control section, infeed traction section, printing section, drying section, outfeed traction section, rewinding section and control section. This machine is an ideal machine for printing paper cup, carton, paper bag and so on.

TECHNICAL DATA

	YT-1000E	YT-1300E	YT-1500E
Paper Thickness	40 ~ 320g/m <sup>2</sup>	40 ~ 320g/m <sup>2</sup>	40 ~ 320g/m <sup>2</sup>
Max. Material Roll Width	1050mm	1350mm	1550mm
Max. Printing Width	1000mm	1300mm	1500mm
Printing Repeat Length	381~1500mm	381~1500mm	381~1500mm
Max. Unwinding Diameter	φ1500mm	φ1500mm	φ1500mm
Max. Rewinding Diameter	φ1500mm	φ1500mm	φ1500mm
Gearing Specification	1/8 CP	1/8 CP	1/8 CP
Registration Accuracy	± 0.1mm	± 0.1mm	± 0.1mm
Max. Speed	300m/min	300m/min	300m/min
Guiding Roller Diameter	φ120mm	φ120mm	φ120mm
Drying Mode	热风干燥和红外干燥 Warm Drying and I.R. Drying		

Production speed will be variable due to different paper, ink and operator's skill.

### YT-D

Unit-type  
Flexo Printing Machine



This machine is a printing machine which adopts flexible photosensitive resin plates, rubber plates as the base material, anilox rollers for transferring ink, liquid ink for printing. It is controlled centrally by PLC system and generally consists of unwinding section, tension control section, infeed traction section, printing section, drying section, outfeed traction section, rewinding section and control section. This machine is an ideal machine for printing paper cup, carton, paper bag and so on.

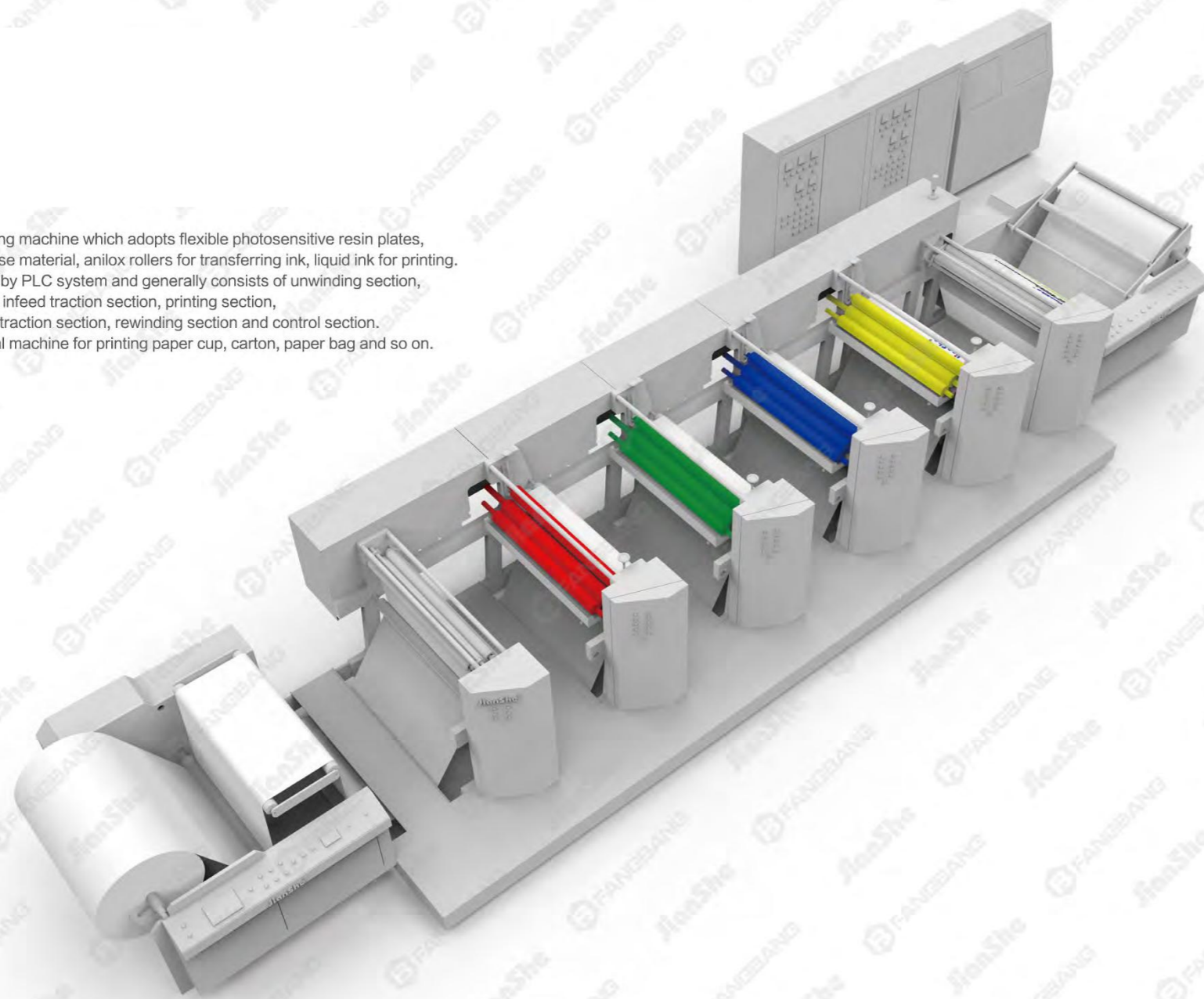

Anilox roller inking structure effectively guarantees printing quality.

The machine has strong adaptability, since it can achieve satisfactory printing effect on various materials, from kraft paper to corrugated board.

The combination of printing units is flexible, because users can increase or decrease printing unit number according to different requirements.

Low-cost printing plate and Low-loss printing process can effectively reduce printing cost, which is 30~50% lower than gravure printing.

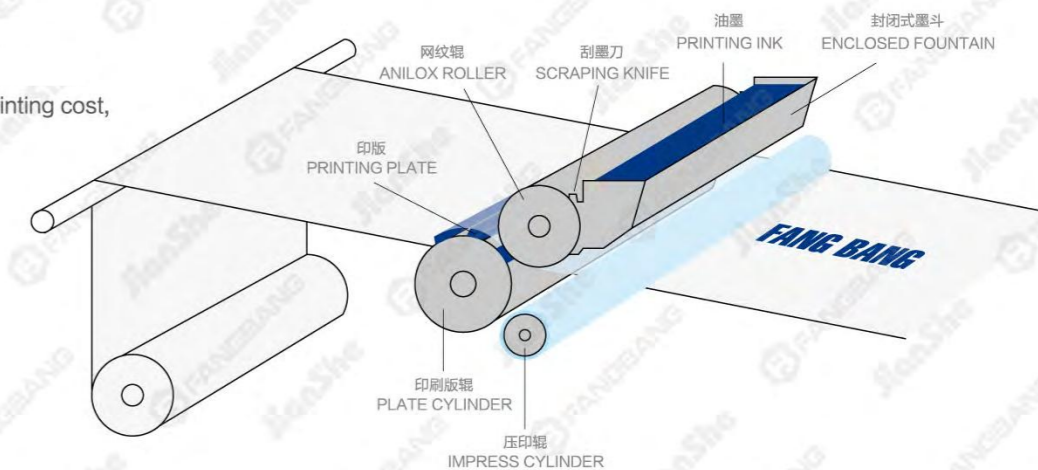

TECHNICAL DATA

	YT-1000C/D	YT-1300C/D	YT-1500C/D
Paper Thickness	40~220 or 220~380g/m <sup>2</sup>	40~220 or 220~380g/m <sup>2</sup>	40~220 or 220~380g/m <sup>2</sup>
Max. Material Roll Width	1020mm	1320mm	1520mm
Max. Printing Width	1000mm	1300mm	1500mm
Printing Repeat Length	285~1200mm(380~1500mm)	285~1200mm(380~1500mm)	380~1500mm
Max. Unwinding Diameter	φ1500mm	φ1500mm	φ1500mm
Max. Rewinding Diameter	φ1500mm	φ1500mm	φ1500mm
Gearing Specification	1/8 CP	1/8 CP	1/8 CP
Registration Accuracy	±0.12mm	±0.12mm	±0.12mm
Max. Printing Speed	150m/min	150m/min	150m/min
Guiding Roller Diameter	φ100mm	φ100mm	φ100mm
Main Motor Power	11kw	15kw	18.5kw
Drying Mode	Warm Drying and I.R. Drying		

Production speed will be variable due to different paper, ink and operator's skill.

### YT-CB

Dual-servo  
Unit-type Flexo Printing Machine



This machine is a printing machine which adopts flexible photosensitive resin plates, rubber plates as the base material, anilox rollers for transferring ink, liquid ink for printing. It is controlled centrally by PLC system and generally consists of unwinding section, tension control section, infeed traction section, printing section, drying section, outfeed traction section, rewinding section and control section. This machine is an ideal machine for printing paper cup, carton, paper bag and so on.

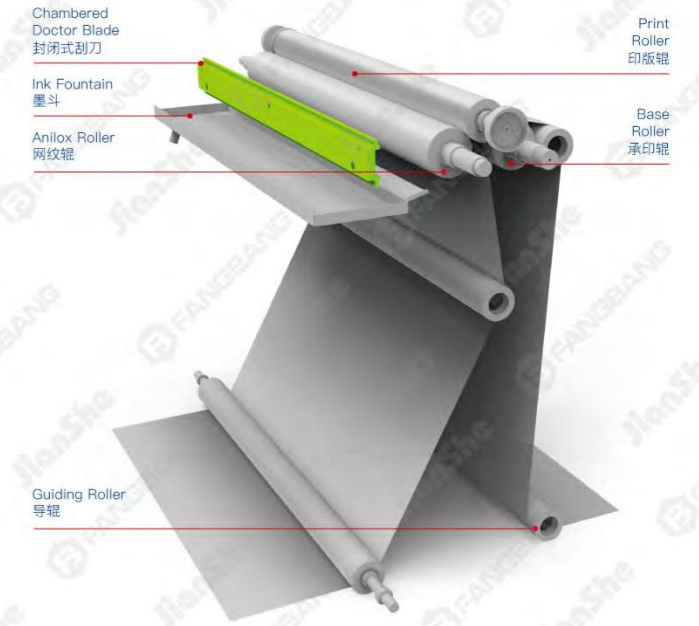

### Technical Data

	YT-1000CB	YT-1300CB	YT-1500CB
Paper Thickness	60~280g/m <sup>2</sup>	60~280g/m <sup>2</sup>	60~280g/m <sup>2</sup>
Max.Material Roll Width	1020mm	1320mm	1520mm
Max. Printing Width	1000mm	1300mm	1500mm
Printing Repeat Length	350~1200mm	350~1200mm	350~1200mm
Max.Unwinding Diameter	Φ1500mm	Φ1500mm	Φ1500mm
Max.Rewinding Diameter	Φ1500mm	Φ1500mm	Φ1500mm
Material Core Diameter	Φ76mm(3")	Φ76mm(3")	Φ76mm(3")
Registration Accuracy	±0.1mm	±0.1mm	±0.1mm
Max. speed	220m/min	220m/min	220m/min
Guiding Roller Diameter	Φ120mm	Φ120mm	Φ120mm
Drying Mode	Warm Drying and I.R. Drying		

Production speed will be variable due to different paper, glue and operator's skill.

### YT-BE

Stack-Type  
Flexo Printing Machine



1. The whole machine is controlled by PLC, ensuring stable production performance.
2. The lifting up and down of printing cylinder is controlled pneumatically; printing ink will be stirred by motor when the printing cylinder lifts up.
3. Adopts reliable drying system coordinated with high-speed rotation, which will automatically break circuit when the machine stops.
4. High-precision planetary gear ensuring 360° continuous longitudinal color registration, coordinated with motor-driven jogging device, makes printing effect more exquisite.
5. Equipped with ceramic anilox roller with chambered doctor metal blade (or metal anilox roller with chambered doctor plastic blade), as well as ink pump circulation.

#### TECHNICAL DATA

	YT-800BE	YT-1000BE	YT-1300BE	YT-1500BE
Max. Material Roll Width	800mm	1000mm	1300mm	1500mm
Max. Printing Width	760mm	960mm	1260mm	1460mm
Max. Un/Rewinding Diameter	Φ1500mm	Φ1500mm	Φ1500mm	Φ1500mm
Printing Repeat Length	200~900mm	200~900mm	200~900mm	200~900mm
Registration Accuracy	±0.2mm	±0.2mm	±0.2mm	±0.2mm
Max. Printing Speed	100m/min	100m/min	100m/min	100m/min
Drying Mode	热风干燥 Warm Drying			

Production speed will be variable due to different paper, ink and operator's skill.

This machine is a traditional stack-type printing machine which adopts flexible photosensitive resin plates, rubber plates as the base material, anilox rollers for transferring ink, liquid ink for printing. Thanks to the traditional machine structure, this machine is suitable for printing on packaging materials such as polyethylene, cellophane and roll paper, etc. It is an ideal printing equipment for producing food packaging, supermarket handbag, vest bag and clothes bag, etc.



### YT-BC

Stack-Type  
Flexo Printing Machine



#### TECHNICAL DATA

	YT-800BC	YT-1000BC	YT-1300BC	YT-1500BC
Max. Material Roll Width	800mm	1000mm	1300mm	1500mm
Max. Printing Width	760mm	960mm	1260mm	1460mm
Max. Un/Rewinding Diameter	Φ1500mm	Φ1500mm	Φ1500mm	Φ1500mm
Printing Repeat Length	230~1000mm	230~1000mm	230~1000mm	230~1000mm
Registration Accuracy	±0.3mm	±0.3mm	±0.3mm	±0.3mm
Max. Printing Speed	100m/min	100m/min	100m/min	100m/min
Drying Mode	热风干燥 Warm Drying			

Production speed will be variable due to different paper, ink and operator's skill.

This machine is a traditional stack-type printing machine which adopts flexible photosensitive resin plates, rubber plates as the base material, anilox rollers for transferring ink, liquid ink for printing. Thanks to the traditional machine structure, this machine is suitable for printing on packaging materials such as polyethylene, cellophane and roll paper, etc. It is an ideal printing equipment for producing food packaging, supermarket handbag, vest bag and clothes bag, etc.





## AUXILIARY EQUIPMENTS

Supporting Paper Bag Machine



You are the leading role, rather than them

But they will be your right-hand

### ZD-SB100

High Speed Paper Handle Machine

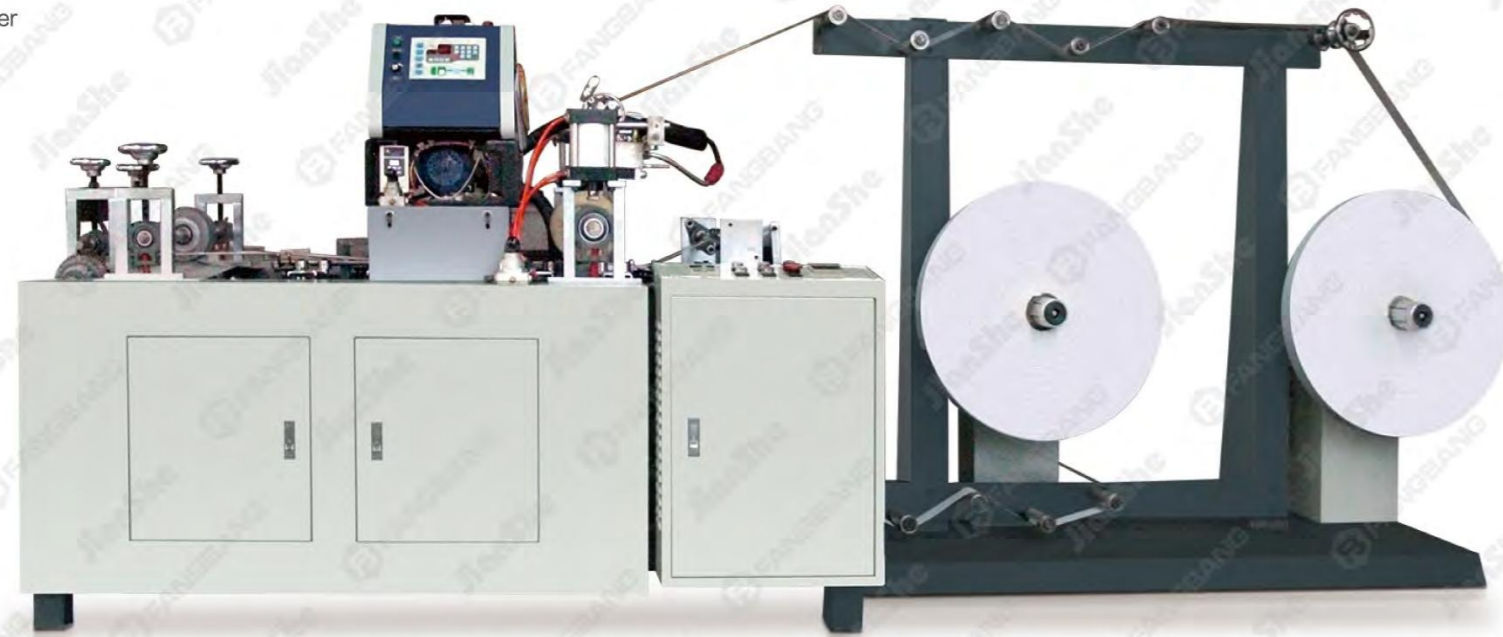

手把规格  
Handle Specification

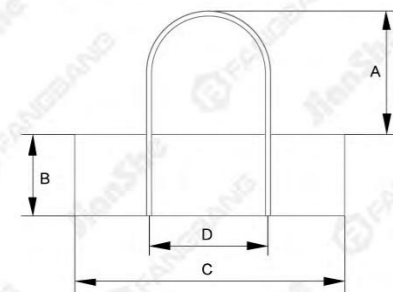

- (A) 手把绳高 Rope Height 100mm
- (B) 贴片宽度 Patch Width 40mm
- (C) 贴片长度 Patch Length 152/190mm
- (E) 纸绳间距 Rope Spacing 76/95mm

#### TECHNICAL DATA

#### ZD-SB100A ( TWISTED HANDLE)

Paper Roll Core Diameter	φ76mm(3")
Max. Paper Roll Diameter	Φ1000mm
Production Speed	7000pairs/hour
Power Requirements	380V, 50Hz, 3 phases, 5 wires
Total Power	5.1kw
Total Weight	Approx. 1500kg
Overall Dimension	L4700 × W1300 × H1600mm

Production speed will be variable due to different paper, glue and operator's skill.

This machine is mainly supporting semi-automatic paper bag machines. It can quickly produce paper handle with twisted rope, which can be attached onto the paper bag without handles in further production and make it into paper handbags. This machine takes two narrow paper rolls and one paper rope as raw material, sticks paper belts and paper rope together, which will be cut off gradually to form paper handles. In addition, the machine also has automatic counting and gluing functions, which can greatly improve the efficiency of subsequent processing operations of users.

Automatic paper handle gluing function speeds up subsequent paper bag processing.

Optional 10-meter conveyer belt brings convenience for further paper bag processing.

Two different gluing configurations: water glue system or hot-melt glue system.



手把规格  
Handle Specification

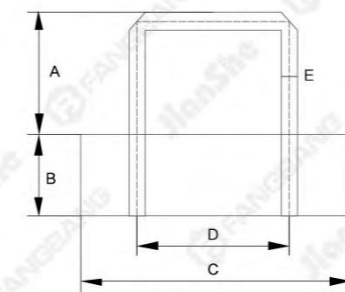

- (A) 手把绳高 Flat Rope Height 100/103mm
- (B) 贴片宽度 Handle Patch Width 40mm
- (C) 贴片长度 Flat Patch Length 152/190mm
- (D) 纸绳间距 Flat Rope Spacing 93/96mm
- (E) 扁绳宽度 Flat Rope Width 12/15mm

#### TECHNICAL DATA

#### ZD-SB100B ( FLAT HANDLE)

Paper Roll Core Diameter	φ76mm(3")
Max. Paper Roll Diameter	Φ 800/1000mm
Production Speed	6000pairs/hour
Power Requirements	380V, 50Hz, 3 phases, 5 wires
Total Power	10kw
Total Weight	Approx. 4000kg
Overall Dimension	L5000 × W1500 × H1500mm

Production speed will be variable due to different paper, glue and operator's skill.

### ZD-YS300

Twisted Paper Rope Machine



This machine is mainly supporting high-speed paper handle machine and paper bag machine. It can quickly produce circular paper rope, so as to provide raw materials for paper handle machine. This machine takes narrow paper roll as raw material, and twists the paper into rope through the fast rotating shaft and keeps the final product in the roll pattern. According to users' different requirements, they can adjust the paper rope diameter directly, as well as customize the special model of this machine, which can simultaneously produce two paper rope rolls on one machine, thus greatly improve production efficiency.

#### TECHNICAL DATA

	ZD-YS300	ZD-YS300D
Paper Roll Core Diameter	76mm (3")	76mm (3")
Max. Paper Roll Diameter	800mm	800mm
Paper Roll Width	30-100mm	30-100mm
Paper Thickness	25-60g/m <sup>2</sup>	25-60g/m <sup>2</sup>
Paper Rope Diameter	φ2.5-6mm	φ2.5-6mm
Rope Roll Core Diameter	90mm	90mm
Max. Rope Roll Diameter	300mm	300mm
Max. Rope Roll Width	300mm	300mm
Production Speed	16-20m/min	30-40m/min
Power Requirements	380V, 50HZ, 3PH	380V, 50HZ, 3PH
Total Power	1.1kw	1.5kw
Total Weight	Approx. 500kg	Approx. 750kg
Overall Dimension	L1800×W1100×H1000mm	L1800×W1500×H1000mm

Production speed will be variable due to different paper, and operator's skill.

### ZD-FJ200

Twisted Paper Rope Rewinding Machine



This machine is mainly supporting twisted paper rope machine. It is applicable to rewind the target paper rope roll, to ensure that the rope can be applied in further productions successfully. This machine takes the paper rope roll produced from twisted paper rope machine as the raw material, releases the roll on one shaft and twines it on the other shaft on the machine. This machine can not only enlarge the diameter of the paper rope roll, but also eliminate rope knots in the raw paper rope roll, so that the application efficiency of paper rope roll can be greatly improved in further productions.

#### TECHNICAL DATA

	ZD-FJ200
Core Diameter of Raw Rope Roll	90mm
Core Diameter of Final Rope Roll	180mm
Final Rope Reel Diameter	400~600mm
Final Rope Reel Height	380mm
Max. Production Speed	150m/min
Power Requirements	380V,50Hz,3 phases,5 wires
Total Power	2.2kw
Total Weight	Approx.120kg
Overall Dimension	L1050 x W800 x H1200mm

Production speed will be variable due to different paper, and operator's skill.

## FQ-1400/1700/1900

Roll-fed Sheet Cutter



The machine is mainly supporting flexographic printing machine and sheet-fed paper bag machine. It can cut the printed paper roll from flexographic printing machine into sheet paper, which can be used as the material of sheet-fed paper bag machine. The machine is equipped with YASKAWA servo motor and AC converter for computer control system, adopts NITTA conveyor belt, FINDEVA pneumatic vibrator and SCHNEIDER/OMRON electrical system, to ensure cutting quickly and stably; Bearing and cutters from Germany, ensure high cutting precision; Touch screen computer interface control, brings simple operations; Anti-curved frame with proper structure, ensures flat sheet paper. As widely adopted in the printing and packaging industry, this machine has advantages including stable performance and low price, so that obtains trust and praise from customers.

## TECHNICAL DATA

FQ-1400/1700/1900A

Paper Cutting Pattern	The upper knife cut reciprocally and the lower knife is fixed	
Max. Paper Roll Width	1400mm/1700mm/1900mm	
Max. Paper Roll Diameter	Φ1800mm	
Paper Thickness	60-550g/m <sup>2</sup> (100-1000g/m <sup>2</sup> 双回旋刀 Double rotary sheeter)	
Cutting Length Range	450-1450mm	
Slitting Format	2 sheets	
Cutting Precision	切断长度 < 1000mm: ±0.5mm 切断长度 > 1000mm: ±0.1% cutting length < 1000mm: ±0.5mm cutting length > 1000mm: ±0.1%	
Max. Cutting Speed By Cut	300cuts/min	
Max. Cutting Speed By Meter	300m/min	
Max. Paper Pile Height	1300mm	
Air Source Requirements	0.8MPa	
Power Requirements	380V/220V, 50Hz	
Total Weight	13000/10500/17000kg	

Production speed will be variable due to different paper, and operator's skill.

## FT-1100A/1300A/1600A

Roll-fed Slitting Machine



The machine is mainly supporting the flexographic printing machine, roll-fed paper bag machine and paper handle machine, etc. It is able to slit paper roll fast in the vertical direction, to produce narrower paper rolls. As a perfect paper processing equipment all over the world, this machine adopts advanced technologies including automatic photoelectric tracking correction, magnetic powder tension control, automatic measuring, photoelectric sensor system and automatic electrical control program. In addition to paper, this machine is also applicable to process plastic film, glass paper, aluminum foil, glass fiber fabric, for coating, packaging, printing and bag making, etc.

## TECHNICAL DATA

	FT-1100A	FT-1300A	FT-1600A
Paper Thickness	40-300g/m <sup>2</sup>	40-300g/m <sup>2</sup>	40-300g/m <sup>2</sup>
Material Core Diameter	φ152mm(6")	φ152mm(6")	φ152mm(6")
Final Material Core Diameter	φ76mm(3")	φ76mm(3")	φ76mm(3")
Max. Unwinding Width	1100mm	1300mm	1600mm
Max. Unwinding Diameter	φ1500mm	φ1500mm	φ1500mm
Max. Rewinding Diameter	φ1000mm/φ1200mm	φ1000mm/φ1200mm	φ1000mm/φ1200mm
Max. Slitting Width	1100mm	1300mm	1600mm
Min. Slitting Width	30mm	30mm	30mm
Max. Production Speed	350m/min	350m/min	350m/min
Power Requirements	380V, 50HZ, 3PH	380V, 50HZ, 3PH	380V, 50HZ, 3PH
Total Power	22kw	24kw	28kw
Air Source Requirements	0.8MPa	0.8MPa	0.8MPa
Overall Dimension	L4300 X W3200 X H2000mm	L4300 X W3400 X H2000mm	L4300 X W3700 X H2000mm
Total Weight	5800kg	6200kg	6600kg

Production speed will be variable due to different paper, and operator's skill.

No matter where our customers are,  
we are able to provide strong technical support and perfect after-sale service,  
to create the desired value for them.

As a high-tech enterprise including research, development, production, sales and service,  
Jiangsu Fangbang Machinery always places machine quality in the first place and pays attention onto customers.  
We insist on combining high-quality materials, advanced design, refined processing,  
aborative assembling and testing,  
strict manufacturing standards and stringent quality assurance system together,  
to manufacture satisfactory products for customers.

Now, we can not be without you, even care more about you

